

# LOOKING FOR A GRAVE IN SEAL CHURCHYARD

## GENERAL NOTES:

### To find a grave in the churchyard:

- find the surname in the list
- note the Grid Reference in the last column
- find it on the map overleaf.

The Grid Reference will give you an approximate location in the churchyard. The grid lines on the map are taken from the What3Words app. Their references are not precise enough to locate graves, but if you have the app, you may find it helpful to use the satellite imagery and count the grid squares to help you search.

**Further details of burials** can be found in the transcript records which are included in this file. There are 6 sets of transcripts referring to different areas of the churchyard. You can find the correct set by looking at the "Transcript Record" reference in the fourth column in the surname list. The second and third numbers in this column refer to the row and plot number of the grave as listed in the records.

1. Leland Duncan records – 18<sup>th</sup>-19<sup>th</sup>C
2. Old North graveyard – Late 19<sup>th</sup> to early 20<sup>th</sup> C
3. North East graveyard – Early to mid 20<sup>th</sup> C
4. North West graveyard – Mid 20<sup>th</sup> to early 21<sup>st</sup> C
5. Cremated remains along the North and West walls of the churchyard.
6. Tower plot – currently in use for burials, between the church tower and the West wall of the church yard

**The oldest graves in the churchyard are in the front of the church.** These do not have grid references, but were mapped in 1921 by Leland Duncan. If the grave you are looking for dates to before the late 19<sup>th</sup> century, this is where it is likely to be.

The sketch map he produced is at the back of this documents along with a list of surnames of those buried in the oldest part of the graveyard. Record set 1 contains more details of these burials.

### PLEASE NOTE:

Not all graves are marked by headstones and older gravestones are often hard to read, so we have not always been able to locate graves with certainty.

In addition, before the mid twentieth century, although burials were recorded in burial registers, they often did not include location information. If you cannot find a grave, this may be the reason. People were content to know that they were buried "in God's Acre" as the churchyard was known, close to the church which so many of them had worshipped in through their lives.



**NORTH WEST GRAVEYARD**

Between trees and field wall, to the left of path.  
Mid 20<sup>th</sup> to early 21<sup>st</sup> C  
Record set 4

**NORTH EAST GRAVEYARD**

between grass path and field wall, to the right of the path. Early 20<sup>th</sup> C  
Record set 3

Cremated remains  
Record sets 5a and 5b

TOWER PLOT  
Betw. ashes plot and path.  
21<sup>st</sup> C  
Record set 6

**OLD NORTH GRAVEYARD**  
Between grass path and church, to right of path.  
Late 19<sup>th</sup> early 20<sup>th</sup> C  
Record set 2

**OLD GRAVEYARD**  
Graves at the front of the church are listed in the records and sketch map of Leland Duncan, made in 1921 (see overleaf). These do not yet have grif refs, but are individually numbered by Duncan. 18<sup>th</sup> to 19<sup>th</sup> C.  
Record set

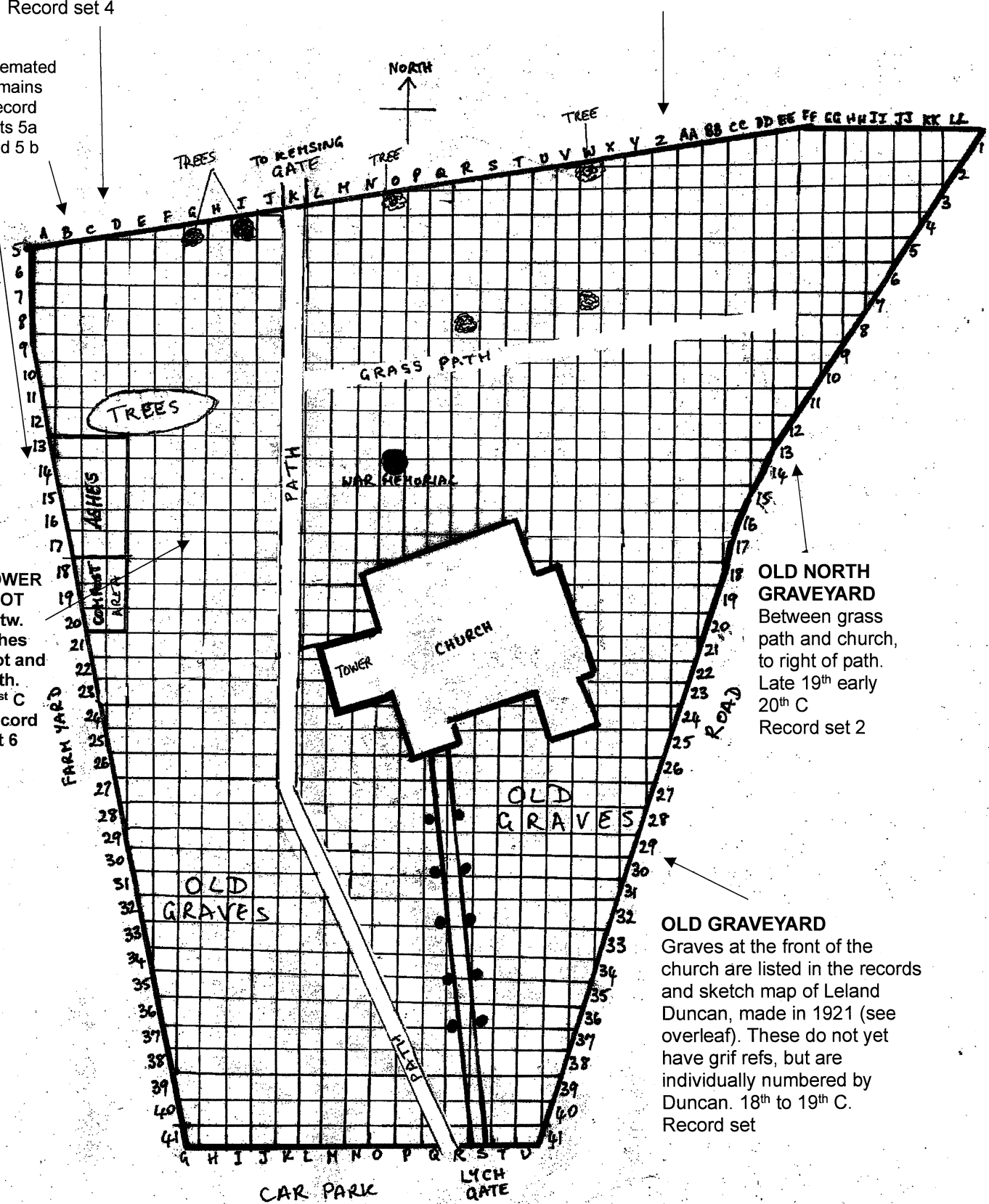



**CHURCHYARD OF ST PETER & PAUL, SEAL, KENT** Seal graveyard - names & Grid refs

Surname	Christian name(s)	Date of burial	Transcript (record/rc)	Grid reference	Notes
ACOTT	Doreen Pretoria	01/09/2007	5b\01\07	B/16	
AITKIN	Edith Florence	07/03/1947	3\15\10	X/3	
AITKIN	Robert William		3\15\10	X/3	Not in burial register?
AL RAIS	Sanharib	08/03/2019	5b\5\14	D/15	
ALDRIDGE	Edward James	13/03/2014	6\2\13	F/16	
ALDRIDGE	Gladys Ethel	23/03/2023	6\2\13	F/16	
ALEXANDER	Evelyn Ferguson	24/02/1887	2\18\1	Z/9	Vicar of St Paul, Walworth. A window in the North Wall
ALLEN	Frederick Wallace	17/04/1915	2\5\1	N/11	War Grave
ALLEN	May Elizabeth	01/04/2000	5a\01	J/4	Ashes
ALWEN	Walter James	31/08/1949	3\15\07	Y/4	
ALWEN	Dorothy	01/09/1991	4\03\08	F/9	
ANSELL	Lucy Florence	18/05/1946	3\14\09	W/4	
ANSELL	William Henry	19/02/1964	3\14\09	W/4	
ARDING	Graham Henry Duff	01/11/1997	5b\01\08	B/16	
ARLOW	Cecil Campbell	19/11/1922	2\12\16	T/16	
ARLOW	Alma Mary	07/03/1953	2\12\16	T/16	
ARNOLD	Barbara Ivy Elizabeth	?/06/2024	5a\36	B/5	
ASHBEE	Janet Elizabeth	?/?/1961	2\10\1	R/10	
ASHBEE	Charles Robert	23/05/1942	2\10\1	R/10	Church Architect, also memorial by font in church
ASHBEE	Jane Felicity	26/07/2008	2\10\04	R/10	
ASHDOWN	Thomas	03/02/1932	3\07\10	P/6	
ASHDOWN	Harriett	20/09/1933	3\07\10	P/6	
ASHDOWN	Ada	22/09/1954	3\19\13	BB/2	
ASKHAM	Jane	25/02/2001	5b\01\21	B/13	
AUBERTIN	Dorothy	01/05/1984	4\05\09	D/10	
AUBERTIN	Arthur Carey Francis	01/05/2010	4\05\09	D/10	
AUTEN	William Blee	24/03/1932	3\07\11	P/6	
AUTEN	Edith Fanny Mary	10/01/1950	3\07\11	P/6	
BAILEY	Marion	10/03/2012	5b\03\14	C/15	
BAILEY	Edith Emily	11/12/1930	3\06\07	P/8	
BAKER	Emily	09/10/1937	4\10\02	S/7	
BAKER	Alma Rosemary	01/08/1991	5a\26	E/4	
BAKER	Stephen	06/03/1963	6\3\3	G/14	
BAKER	Elsie Emma	16/11/1968	6\3\3	G/14	
BALCOMB	William John	26/07/1989	5a\20	F/4	
BALCOMB	Kathleen Mabel Murray	26/07/1989	5a\20	F/4	
BALCON	Sarah (Sally) Patricia	12/12/2022	2\17\15	Y/15	
BALCON	Jonathan Michael Henry	21/06/2012	2\17\15	Y/15	
BALDWIN	John	20/08/1916	3\07\12	P/6	INSCRIPTION ONLY , BURIED AT ABBEVILLE

**CHURCHYARD OF ST PETER & PAUL, SEAL, KENT** Seal graveyard - names & Grid refs

Surname	Christian name(s)	Date of burial	Transcript/rc (record/rc)	Grid reference	Notes
BALDWIN	Sophia	11/08/1932	3\07\12	E/10	
BALDWIN	Benjamin	22/03/1934	3\07\12	P/6	
BALDWIN	Rose	07/07/1993	5a\36	B/5	
BALFOUR	Mary Elizabeth	01/12/1988	4\07\08	C/8	
BALFOUR	David Mathers	25/08/2001	4\07\08	C/8	
BAMPTON	Arthur Matthew	12/10/1935	4\09\03	S/7	
BAMPTON	Irene Nora	13/05/1986	4\09\03	S/7	
BANCROFT	Ronald George Frederick	01/09/1966	4\01\05	E/10	
BANCROFT	Doris Barbara		4\01\05	E/10	
BANFIELD?	Florence Emily?	?14/04/1908	2\13\15	U/16	
BANGAY	Eric	25/11/2010	6\2\8	F/15	
BANGAY	Helen Ann	14/02/2020	6\2\8	F/15	
BANNER	Michael Edward	01/10/1994	4\09\02	I/5	
BARDEN	Sarah Ann	22/01/1940	3\11\11	T/3	
BARDEN	Lewis	02/04/1954	3\18\10	AA/3	
BARDEN	Emily	20/11/1973	3\18\10	AA/3	
BARHAM	Archie David	15/03/1941	3\12\08	U/5	
BARHAM	Wilson	03/12/1941	3\12\08	U/5	
BARHAM	Donald Beaumont	01/02/1986	4\05\11	A/10	
BARHAM	Jane	07/11/1902	2\12\12	T/14	
BARHAM	William	25/04/1909	2\12\12	T/14	
BARHAM	Harold	29/12/1930	2\12\12	T/14	
BARHAM	Ada Constance	20/02/1937	2\12\12	T/14	
BARHAM	Archie David	12/03/1941	2\12\12	T/14	
BARHAM	Ernest William	15/02/1928	2\12\12	T/14	
BARMAN	Henrietta Lemaine Palford	02/03/1927	3\03\07	M/7	
BARRETT	Muriel Adelaide	01/06/2003	4\12\09	D/5	
BARRETT	George Gordon	04/12/2006	4\12\09	D/5	
BARROW	Sidney Samuel William	11/02/1919	2\7\16	P/16	
BARTON	Henry George	01/10/1970	4\02\03	H/10	
BARTON	Kate	01/03/1982	4\02\03	H/10	
BARTY	Mary	01/07/2000	5b\01\19	B/13	
BASHFORD	B. B. W.	09/07/1886	2\9\1	Q/10	
BASHFORD	Margaret	15/16/1888	2\9\1	Q/10	
BASSETT	Charles	?/?/1890	2\17\5	Y/11	
BASSETT	Ann	03/01/1932	2\17\5	Y/11	
BASSETT	Gilbert	22/05/1935	2\19\4	AA/11	
BASSETT	Minnie Susannah	07/02/1956	2\19\4	AA/11	
BASTONE	May Amelia	06/11/1958	3\24\14	GG/1	

**CHURCHYARD OF ST PETER & PAUL, SEAL, KENT**

Seal graveyard - names &amp; Grid refs

Surname	Christian name(s)	Date of burial	Transcript (record/ro)	Grid reference	Notes
BASTONE	Gladys Mary	19/01/1973	3\24\14	GG/1	
BAVIN	Alan Richard	20/08/2012	5b\03\15	C/15	
BECKINSALE	Daisy	25/11/1960	3\07\04	Q/10	
BEISIEGEL	Ernest Cecil	28/09/1954	3\20\14	CC/1	
BENNETT	Eveline Margarethe	12/09/2016	6\2\3	F/13	
BENSTED	Trevor	01/06/1994	5a\39	A/5	
BERESFORD	Joseph David Joshua Luke	01/07/2017	5a\1aa	J/5	
BERESFORD-JONES	William Peter	01/12/1990	4\01\04	H/10	
BERRY	Harold Ernest Frederick	01/03/1991	5a\22	F/4	
BERRY	May Beatrice (Bertha?)	04/08/1892	2\16\1	X/9	
BERRY	Ellen Clara	2/11/1891	2\16\1	X/9	
BERRY	Mary Jane	08/05/1916	2\16\1	X/9	
BERRY	Louis Charles	25/01/1928	2\16\1	X/9	
BERWICK	Edith	01/01/1972	4\02\08	D/10	
BERWICK	Stanley Victor	01/04/1972	4\02\08	D/10	
BIDELEUX	Richard Geoffrey	09/12/2021	6\3\1	G/13	
BIDELEUX	Geoffrey Ferdinand	04/04/1966	6\3\2	G/13	
BIDELEUX	Eleanor Joyce	25/05/2002	6\3\2	G/13	
BIGGS	Jessie Ellen	01/11/1927	3\03\12	M/5	
BIGGS	Nora Ramsay	01/11/2006	5b\02\25	B/13	
BIGGS	Laurence Bermont	21/04/2013	5b\4\4	C/17	
BING	Arthur William	05/06/1939	3\11\02	T/7	
BING	Alice Jane	13/10/1947	3\11\02	T/7	
BING	Alfred James	28/07/1948	3\11\02	T/7	
BISHOP	Susan Mary	24/11/1936	3\03\01	M/9	
BLACKABY	Anna Maria	01/01/1945	3\13\10	V/4	
BLACKABY	Dorothy Mary	19/08/1977	3\13\10	V/4	
BLACKMAN	Lucie	01/03/2005	5b\02\18	B/14	
BLOOMFIELD	Ernest	18/07/1956	3\21\10	DD/3	
BOAKES	Horace John	01/11/1982	4\04\11	A/10	
BOAKES	Joyce Mary	01/02/2002	4\04\11	A/10	
BOARDMAN	Gloria Hazel	01/02/1987	5a\11	H/4	
BOILING	Douglas	01/09/2003	5b\02\13	B/15	
BOLER	Beatrice		5b\4\16	C/14	Stone only. Ashes buried elsewhere
BONE	George	07/01/1953	3\18\12	AA/2	
BOOTH	Wilfred	19/11/1960	3\24\11	GG/3	
BOOTH	Emily Hannah	19/11/1960	3\24\11	GG/3	
BOTTEN	Ambrose Frederick	05/12/1940	3\12\14	U/3	
BOWKER	Kathleen Annie	01/04/1997	4\09\09	C/7	

**CHURCHYARD OF ST PETER & PAUL, SEAL, KENT** Seal graveyard - names & Grid refs

Surname	Christian name(s)	Date of burial	Transcript (record/rc)	Grid reference	Notes
BOWRA	Jane	12/03/1943	3\12\07	U/5	
BOWRA	William	29/03/1958	3\23\15	FF/1	
BOWRA? BOWDEN?	Mary Ann?	?	2\13\13	U/14	
BOYNE	George William	04/11/1915	2\5\3	N/12	War Grave
BOYSE	Brian	24/05/2013	5b\4\22	C/13	
BOYSE	Pamela	05/11/2021	5b\4\22	C/13	
BRADBERRY	Rose Mary	01/01/1892	2\2\15	L/17	
BRADBERRY	Robert William	03/09/1980	2\2\15	L/17	
BRADBERRY	May Beatrice	01/09/1975	2\2\15	L/17	
BRADBERRY	Ralph	27/11/1905	2\11\8	S/14	
BRADBERRY	John	02/12/1909	2\11\8	S/14	
BRADBERRY	Askon Maria	28/02/1937	2\11\8	S/14	
BRANDON	Lionel Hugh	23/04/1946	3\14\10	W/4	
BRANN	Martin	01/09/1982	4\07\02	J/8	
BRANN	Valerie	01/09/1982	4\07\02	J/8	
BRANN	Nicholas	01/06/1986	4\07\02	J/8	
BRANN	Frederick		4\07\02	J/8	
BRANSON	Beverley Winitfred	16/09/1937	3\02\15	L/5	
BRAY	Henry Matthew	17/03/1951	3\17\09	Z/4	
BREACH	Lilias Mary	03/12/1927	3\04\02	N/10	
BREED	Arthur William	07/03/1950	3\16\03	Y/7	
BREED	Hilda Agnes	09/06/1984	3\16\03	Y/7	
BREED	Annie Dorothy Lynn	01/08/2000	3\16\03	Y/7	
BRITTAIN	Walter	01/09/1994	4\09\01	J/7	
BROOKS	John	08/07/1940	3\11\06	T/5	unmarked
BROOKS	Betsy	08/07/1940	3\11\06	T/5	
BROOKS	Edith Mildred	28/06/1956	3\21\11	DD3	
BROWN	Emma Eleanor	19/10/1900	2\7\2	P/10	
BROWN	Mary Elizabeth	20/08/1920	2\8\10	Q/11	
BROWN	George Thomas	22/12/1906	2\12\15	T/16	
BROWN	Rose Ann	?	2\12\15	T/16	
BROWN ?	David Carrog?	?	2\13\9	U/11	Child aged 5. Details are guesses from burial register
BROWNLLOW	Margaret Eileen	01/03/1968	4\01\07	E/10	
BRYANT	Timothy	21/8/1880	2\14\8	V/12	
BRYANT	Priscilla	18/03/1891	2\14\8	V/12	
BUCKLAND	William	07/11/1953	3\18\13	AA/2	
BUCKLAND	Emily	01/04/1957	3\18\13	AA/2	
BULLEID	Jacqueline	17/12/2016	5a\1a	J/4	
BUUR	Frederick Francis	01/05/1974	4\03\07	G/9	



**CHURCHYARD OF ST PETER & PAUL, SEAL, KENT** Seal graveyard - names & Grid refs

Surname	Christian name(s)	Date of burial	Transcript (record/rc)	Grid reference	Notes
BURRELL	Graham Keith	01/02/2005	5b\02\17	B/14	
BURROWS	Karl	24/05/2018	5b\5\10	D/16	
BURSON	Susan	28/03/1934	3\04\14	N/5	
BURTON	Frances Bessie	22/10/1962	3\25\09	HH/4	
BURTON	Edward James	16/08/1968	3\25\09	HH/4	
BURTON	Ronald James	01/01/2002	5b\02\04	B/17	
BUSS	Patricia Mary	09/09/2012	5b\03\23-4	C/13	
BUSS	Frank	27/06/2009	5b\03\23-4	C/13	
BUSSELL	William	06/09/1930	3\05\10	O/7	
BYFORD	Margaret Ellen	01/08/1973	4\03\01	J/9	
BYFORD	Donald Sydney Jesse	01/05/1996	4\03\01	J/9	
CALDER	Alice Harriet	06/06/1935	3\08\13	Q/3	
CALDER	George Alexander	01/05/1945	3\08\13	Q/3	
CAMPBELL	Catherine	24/01/1933	3\03\14	M/4	
CARD	Thomas	06/11/1910	2\11\1	S/9	
CARD	Felicie Jenny	17/11/1928	2\11\1	S/9	
CARD	Louisa Alice	16/09/1956	2\11\1	S/9	
CARD?	Albert?	?/??1894?	2\16\2	X/10	Details guesswork based on old Burial Register
CAREY	Charles	03/04/1895	2\19\14	AA/15	
CARNELL	William	26/04/1875	2\14\9	V/13	
CARRERAS	Eileen Mary	01/04/2002	5b\02\08	B/16	
CHAMPION	Mary Ann	20/01/1897	2\13\1	U/9	
CHAPMAN	Ellen Rose	27/04/1950	3\16\02	Y/7	
CHAPMAN	Charles Henry	07/08/1972	3\16\02	Y/7	
CHAPMAN	Gordon Richard	19/07/2018	5b\5\12	D/15	
CHARLTON	Jean Eileen	01/01/1986	5a\13	G/4	
CHARLTON	Drummond Grant	01/12/1991	5a\13	G/4	
CHECKLEY	David	27/03/2019	5b\5\15	D/15	
CHEESEMAN	Walter Herbert	16/05/1931	4\07\02	Q/11	
CHEESEMAN	Gareth	01/04/1994	5a\38	B/5	
CHITTOCK	Derek James	28/05/1986	5a\12	G/4	
CHOWN	Arthur Francis	25/09/2015	3\25\11	HH/3	
CHOWN	Mary	17/06/1964	3\25\11	HH/3	
CHOWN	Albert	25/04/1969	3\25\11	HH/3	
CHRISTY	Mary Louisa	15/10/1932	3\06\14	P/5	
CHURCHMAN	Alice Mary	01/12/2004	5b\02\16	B/14	
CIECIERSKI	Victor Herbert	01/06/1987	5a\18	F/4	
CIECIERSKI	Joyce Pearl Rennie	01/03/2005	5a\18	F/4	
CLARK	Frank	24/12/1951	3\17\05	Z/6	

**CHURCHYARD OF ST PETER & PAUL, SEAL, KENT** Seal graveyard - names & Grid refs

Surname	Christian name(s)	Date of burial	Transcript (record/rd)	Grid reference	Notes
CLARK	Lily	31/07/1954	3\17\05	Z/6	
CLARK	Louisa Morrison	18/02/1955	3\20\12	CC/2	
CLARKE	James Frederick	23/10/1939	3\11\05	T/6	
CLARKE	Cecil Arthur	27/07/1956	3\22\15	EE/1	
CLAYTON	Thomas	19/09/1927	3\03\11	M/5	
CLAYTON	Sarah Anne	28/12/1929	3\03\11	M/5	
CLODE	Enid Helen	28/11/1954	3\12\15	DD/1	
CLODE	Herbert Beresford	25/02/1958	3\21\15	DD/1	
CLODE	David Beresford	27/06/1998	3\21\15	DD/1	
COCHRANE	Arthur Blair Dundonald	18/06/1936	4\09\10	R/4	
COLDBREATH	Avis Mary Ellen	01/09/1983	5a\02	J/4	
COLDBREATH	Herbert William	01/09/1983	5a\02	J/4	
COLE	Christopher Charles Harry	01/12/1985	4\06\03	H/8	
COLE	Patricia Margaret	01/11/1995	4\06\03	H/8	
COLLINS	Anne Elizabeth Jane	29/03/1930	3\05\05	O/10	
COLLINS	Kaye Martin	24/06/1931	3\07\03	O/10	
COLLINS	Louise Rose	21/06/1947	3\05\05	O/10	
COLLINS	Sylvia Julia	01/07/2001	4\10\10	B/6	
COLLINSON	Hakniss	02/01/1923	3\01\01	L/9	
COLLINSON	Anna Clare	10/03/1927	3\01\01	L/9	
COLLISON	Mira Clare	08/09/1937	4\09\14	R/3	
COLLISON	Harry	16/08/1946	3\14\07	W/5	
COLLISON	Ada	20/04/1964	3\14\07	W/5	
COMBER	Frederick Henry	03/12/1929	3\05\04	O/10	
COMBER	Alice Lucy	22/8/1895	2\15\6	W/11	
COMBER	Henry	13/03/1913	2\15\6	W/11	
COOK	William	09/08/1957	3\22\11	EE/3	
COOK	Jane	15/11/1971	3\22\11	EE/3	
COOKE	Ann	01/02/1987	5a\14	G/4	
COOKSON	Hugh	17/02/1944	3\13\13	V/3	
COOKSON	Violet Geraldine	20/01/1968	3\13\13	V/3	
COOMBES	Alice Edith	01/03/1957	3\22\12	EE/2	
COOPER	Stanley Wlrm	27/01/1933	3\08\01	R/8	
COOPER	Eliza	16/11/1937	4\10\03	S/7	
COOPER	William	27/05/1949	3\15\10	Y/4	
COOPER	Caroline Victoria	16/01/1954	3\15\10	Y/4	
COOPER	Phoebe Estelle	19/12/1962	3\08\01	R/8	
CORKE	Gamber	22/12/1923	3\01\04	L/8	
CORKE	James	23/06/1925	3\01\04	L/8	Jan, found dead at the Paddock Seal, supposed to be Ja

**CHURCHYARD OF ST PETER & PAUL, SEAL, KENT** Seal graveyard - names & Grid refs

Surname	Christian name(s)	Date of burial	Transcript (record/ro)	Grid reference	Notes
CORKE	Charles Frederick	01/03/1935	3\01\04	L/8	
CORKE	Richard	?/?/1909	2\1\18	M/20	In corner between tower and north west corner of chun
CORKE	Emma	?/?/1915	2\1\18	M/20	In corner between tower and north west corner of chun
COTTER	Jack Wallace Tremlett	01/07/1991	4\08\03	H/7	
COTTER	Sheila Maud	11/10/2008	4\08\03	H/7	
COUCHMAN	Rose	10/09/1929	3\05\03	O/10	
COWLAND	George Arthur	08/07/1929	3\05\02	O/11	
COXEN	George William, Sir	11/04/1946	3\15\14	X/2	1st Baronet Seal, Lord Mayor of London
COXEN	Kathleen Alma, Lady	29/10/1998	3\15\14	X/2	
CRADDOCK	Walter	07/08/1921?	2\5\5	N/12	
CRADDOCK	Leslie? David	02/12/1918?	2\5\5	N/12	
CRADDOCK	Isabella	15/10/1921	2\4\8	N/12	
CRAWSHAW	Maud	27/05/1925	3\01\11	K/6	
CRESSWELL	Sarah (Polly)	13/09/2019	5b\4\23	C/13	
CRESSWELL	Eric	05/11/2021	5b\4\23	C/13	
CRITTEN	Henry	06/03/1937	4\09\11	R/4	
CROFT	William Frederick	29/10/1962	3\20\09	CC/3	
CROFT	Ida	06/06/1975	3\20\09	CC/3	
CRONK	Florence Burgrave	10/03/1915	2\14\11	V/13	
CRONK	Ernest	13/01/1920	2\14\11	V/13	
CRONK	William Douglas	02/02/1947	2\14\11	V/13	
CROUCH	Ann	04/03/1895	6\1\5	E/16	
CRUICKSHANK	Eleanor	12/07/1941	3\12\12	U/3	
CRUICKSHANK	Robert	07/10/1943	3\12\12	U/3	
CURTIS	Abraham	29/01/1925	3\02\03	L/8	
CURTIS	Catherine	08/03/1930	3\02\03	L/8	
CURTIS	Jane Ann	31/01/1931	3\06\12\13	P/6	
CURTIS	George Henry	09/06/1932	3\06\12\13	P/6	
CURTIS	Fanny	27/07/1935	3\06\12\13	P/6	
CURTIS	Lois Eunice	23/09/1937	4\10\01	S/8	
CURTIS	Helen	21/08/1948	3\06\12\13	P/6	
CURTIS	John Knell	23/02/1930	2\10\17	R/16	
CUTHBERT	Katherine (Kay) Florence	06/06/2018	5b\5\11	D/15	
CUTMORE	Nora Patricia	02/09/1932	3\07\13	P/5	
DANIELS	Irene Ada	17/08/2011	5b\03\13	C/15	
DANIELS	Leonard Seymour	26/08/1987	5a\19	F/4	
DARLING	James	14/11/1943	3\13\14	V/2	
DAVEY	William Thomas	08/10/1959	3\24\13	GG/2	
DAVEY	Alice	17/03/1966	3\24\13	GG/2	

# CHURCHYARD OF ST PETER & PAUL, SEAL, KENT

Seal graveyard - names & Grid refs

Surname	Christian name(s)	Date of burial	Transcript (record/rc)	Grid reference	Notes
DAVIS	Lilian Rosetta	14/07/1940	3\11\09	T/4	
DAVISON	Robert	15\04\1871	2\15\16	W/15	Of Underriver House. Paid for building of St Margaret U
DAVISON	Arthur P	19\08\1955	2\15\16	W/15	
DAVISON	Dorothy Georgiana May	30\06\1956	2\15\16	W/15	
DAVISON	John Arthur	16\10\1942	2\15\16	W/15	
DAVISON	Jane Anna	16\11\1869	2\15\16	W/15	
DAY	Edgar	09\09\1930	3\05\11	O/7	
DAY	Grace Ethel	01\02\1947	3\15\12	X/2	
DAY	Eric Victor	18\11\2013	5b\4\5	C/17	
DAY	Kathleen	17\06\2016	5b\4\5	C/17	
DEAN	Elsie Constance Rhoda	01\10\1986	4\06\09	D/7	
DEAN	Eric Hubert	01\08\2000	4\06\09	D/7	
DEVITT	Fanny Theodora	01\01\1917	2\1\9	K/14	
DEVITT	Thomas Lane	01\01\1923	2\1\9	K/14	
DEVITT	Helen Margaret	15\09\1932	2\1\9	K/14	
DEVITT	Emily Ruth	01\01\1960	2\1\9	K/14	not in burial register. May be buried elsewhere. Memor
DEVITT	Thomas	23\12\1995	2\7\7	P/11	2nd Baronet Large, enclosed grave
DEWAR	Edith Mary	01\03\1983	4\05\08	D/10	
DICKENS	Roy Edmund	01\10\1995	5b\01\03	B/17	
DICKS	Ethel	12\03\1959	3\23\11	FF/3	
DINE	Patricia Dorothy Beatrice	09\05\2016	5a\21	F/4	
DINE	Robert Edward Frederic	01\08\1989	5a\21	F/4	
DODD	Christina Betty	13\08\1911	2\12\16	T/16	
DOE	Margaret Deborah Laird	31\05\1998	3\06\01\02	P/11	
DOGGETT	Louisa Maria	15\10\1921	2\4\8	N/12	Died on same day as her sister Isabella Craddock at G
DOGGETT	James Cox	25\05\1926	2\4\8	N/12	
DON	George Robert Anderson	01\07\1978	4\04\07	E/9	
DON	Betty	01\05\2010	4\04\07	E/9	
DOOREY	Constance Caroline	01\11\1977	4\03\10	B/10	
DORAN	Jonathan Peter	01\01\1994	4\08\10	B/8	
DOWN	Oliver	24\02\2010	5b\3\4	C/17	
DOWNNS	Armstrong	19\12\1931	3\07\08	Q/7	
DRAWBRIDGE	Bessie	01\03\1989	4\02\01	J/10	
DRAWBRIDGE	Ernest	01\11\1990	4\02\01	J/10	
EASTER	Kenneth Robert	01\08\2005	5b\02\19	B/14	
EATTELL	Madeline	01\06\1999	5b\01\15	B/14	
EDGLEY	Lesley Charles	01\02\1995	5a\42	A/5	
EDMUNDS	Cecie Adrian	10\10\1986	5\05	I/4	
EDMUNDS	Elizabeth Love	10\10\1986	5\05	I/4	

**CHURCHYARD OF ST PETER & PAUL, SEAL, KENT**

Seal graveyard - names &amp; Grid refs

Surname	Christian name(s)	Date of burial	Transcript (record/rd)	Grid reference	Notes
EDWARDS	Jack	23/02/1946	3\14\13	W/3	
EDWARDS	Mary Emily	23/02/1946	3\14\13	W/3	
EDWARDS	Benjamin Harris	01/04/1988	4\07\06	E/8	
EDWARDS	Nancy	01/10/1995	4\07\06	E/8	
EDWARDS	Frances Olive	01/10/1998	5b\01\12	B/15	
EDWARDS	Frank Zachariah	05/11/1904	2\12\10	T/12	
ELDRIDGE	Eleanor Elizabeth	01/01/1998	4\09\11	A/7	
ELDRIDGE	Alfred George	06/03/1940	3\12\15	U/2	
ELLIS	George	19/09/1893	2\16\4	X/11	
ELLIS	Eliza	25/03/1907	2\16\4	X/11	
ELLIS	Robert	03/01/1917	2\21\7	CC/9	
ELLIS	Sarah	?/?/?	2\21\7	CC/9	
ELLISON	Eliza	20/07/1914	2\10\17	R/16	
EMBURY	Edward	10/07/1935	3\09\01	S/8	
EMUS	Denis Frank Ritchie	10/03/2008	5b\03\22	C/13	
EMUS	Eileen Alice	01/10/2008	5b\03\22	C/13	
ENTHOVEN	Ida Marjorie	05/10/1895	2\22\1	HH/8	
ENTHOVEN	Ernest James	19/02/1936	2\22\1	HH/8	
ENTHOVEN	Rosalind May	02/05/1947	2\22\1	HH/8	
ENTHOVEN	Evelyn Russell	04/07/1897	2\22\1	HH/8	
ENTHOVEN	Roderick E	?/?/1985	2\22\1	HH/8	
ENTHOVEN	Cecilia Mary	?/?/2000	2\22\1	HH/8	
ENTHOVEN	Simon Le Mesurier	27/10/2018	2\22\1	HH/8	
ETTINGER	Jane	29/06/2024	5a\1\0	J/5	
EVANS	Gillian Lesley	09/04/1965	3\26\09	II/4	
EVANS	Alfred Dennis	14/04/1965	3\26\09	II/4	
EVANS	Alan Dennis	01/09/1984	4\05\10	C/10	
EVANS	Nealie Hester	01/12/1991	4\05\10	C/10	
EVANS	Giles William Simon	22/04/2000	4\08\07	D/8	
EVANS	Mary Priscilla	20/11/2010	4\08\07	D/8	
EVANS	Robin	01/01/1993	4\08\07	D/8	
FARR	Emily Charles	01/01/1898	2\11\2	K/11	
FAWCETT	Catherine Anne	01/05/1972	4\02\10	B/9	
FAWCETT	Elizabeth Barbara Joyce	01/12/1978	4\02\10	B/9	
FAWCETT	George Edward	01/05/1982	4\02\10	B/9	
FENNER	Nicholas	01/07/1887	2\14\3	V10	
FENNER	Caroline	06/08/1897	2\14\3	V10	
FERGUSON	Alan Joseph	25/03/2021	5B\6\4	D/17	
FERMOR	Arthur	01/01/1997	5b\01\05	B/16	

*Under hawthorn tree near field gate*
*plot by churchyard wall*

**CHURCHYARD OF ST PETER & PAUL, SEAL, KENT** Seal graveyard - names & Grid refs

Surname	Christian name(s)	Date of burial	Transcript (record/rc)	Grid reference	Notes
FERMOR	May	01/07/2000	4\03\07	G/9	
FEW	Dora Mary	29/6/1888	2\20\1	BB/8	
FEW	Mary	30/07/1914	2\20\1	BB/8	
FEW	Charles Edward	03/04/1922	2\20\1	BB/8	
FEW	Evelyn Louisa	?/?/?	2\20\1	BB/8	
FIELD	George Edward	01/08/1994	4\08\11	A/8	
FISHER	Frederick	01/12/1970	4\02\04	G/10	
FISHER	Mildred Blanche	01/10/1979	4\02\04	G/10	
FLANAGAN	George	01/10/1992	5a\30	D/4	
FLANAGAN	Eve	21/05/2006	5a\30	D/4	
FLEGG	Nellie Margaret	21/02/1946	3\14\14	W/2	
FOLKES	William John	22/09/1951	3\17\07	Z/5	
FOLKES	Catherine	15/05/1958	3\17\07	Z/5	
FORBES	Francis Augustine	22/12/1911	2\10\1	R/10	Arts & Crafts stone cross, designed by Charles Ashbee
FORBES	Jessie Mary	?/02/1924	2\10\1	R/10	
FORBES	Nevill	13/02/1929	2\10\1	R/10	
FORBES-SIMPSON	Ethel Newton	06/06/1963	3\25\08	HH/4	
FORBES-SIMPSON	John Archibald	10/05/1967	3\25\08	HH/4	
FOX	Amy Helen	11/06/2011	5a\15	G/4	
FOX	Bertie	01/05/1987	5a\15	G/4	
FOX	Malcolm Jonathan	01/03/2012	6\2\9	F/15	
FRENCH	Percy John	14/01/1952	3\17\01	Z/7	
FRIEND	Heather Margaret	01/06/1999	5b\01\14	B/14	
FRYER	Florence Lily	05/04/1943	3\12\01	U/8	
FUGGLE	George	05/12/1931	3\07\06	Q/9	
FUGGLE	Mary Ann	23/01/1932	3\07\06	Q/9	
FUGGLE	Katie Elizabeth	17/08/1946	3\15\13	X/2	
FUGGLE	Mary Louise	14/12/1948	3\15\13	Y/3	
FUGGLE	Alice Helena	16/06/1967	3\15\13	Y/3	2nd wife of Harry Fuggle
FUGGLE	Harry	18/08/1967	3\15\13	X/2	
FULLER	William	25/01/1916	2\6\5	O/12	
FULLER	William	25/01/1916	2\6\5	O/12	
FULLER	Lydia	09/07/1933	2\6\5	O/12	
GAGE	George William	23/07/1938	4\10\07	S/5	
GAGE	Charles James	28/01/1950	3\15\05	Y/6	
GAGE	Ada Kate	09/01/1971	3\15\05	Y/6	
GAISFORD	Eleanor Patience	24/09/1930	3\05\12	O/6	
GAISFORD	Thomas Thaddeus	05/11/1932	3\05\12	O/6	
GAISFORD	Charles	02/12/1944	3\13\11	V/3	

**CHURCHYARD OF ST PETER & PAUL, SEAL, KENT** Seal graveyard - names & Grid refs

Surname	Christian name(s)	Date of burial	Transcript (record/rc)	Grid reference	Notes
GAISFORD	Florence Maud Louise	02/12/1944	3\13\11	V/3	
GALE	Ralph Leslie Ronald	01/03/1975	4\05\01	J/9	
GALE	Charles Ronald	01/03/1975	4\05\01	J/9	
GALE	Margaret	01/04/2005	4\05\01	J/9	
GALE	Sarah Elizabeth	01/12/2008	5b\01\19	B/13	
GARDNER	Katharine Wendy	01/01/2002	4\11\05	G/5	
GASH	Sarah Ann	01/01/1968	4\01\06	F/10	
GASH	Margaret Mary	21/11/2014	4\1\6	F/10	
GATEHOUSE	Glafina	01/03/1982	4\06\01	J/8	
GATEHOUSE	Peter	01/09/2004	4\06\01	J/8	
GEER	Reginald	01/01/1993	5a\32	C/5	
GEER	Riki Stephen	21/05/2022	5b\6\5	D/17	
GETGOOD	Penny' Lilian Ellen	01/11/1997	4\09\10	B/7	
GIBBS	Peter William	01/03/1919	2\4\16	N/16	
GIBBS	Frances	10/08/1931	2\4\16	N/16	
GIBBS	Mary	23/08/1950	2\4\16	N/16	
GILBERT	Reginald Alfred	01/02/1983	4\05\07	E/10	
GILBERT	Hilda Lucy	01/06/1993	4\05\07	E/10	
GILBERT	Rose Lilian	01/03/2004	4\12\07	D/5	
GODDEN	Ruby	01/04/1974	4\03\06	G/9	
GODFREY	Mildred Doris Maud	16/09/1937	3\02\16	L/5	
GODFREY	Alfred Sidney	03/07/1952	3\17\02	Z/7	
GODFREY	George Henry	05/01/1953	3\18\15	AA/1	
GODFREY	Jane Fanny	07/03/1958	3\17\02	Z/7	
GODFREY	George Alfred	01/07/1968	4\01\08	D/11	
GODFREY	Maude	01/08/1984	4\01\08	D/11	
GODFREY	George Sidney	01/03/2000	5b\01\16	B/14	
GODFREY	Hetty	01/01/2002	5b\02\06	B/16	
GODFREY	Alfred	01/06/2006	5b\02\06	B/16	
GODFREY	George	28/02/1894	2\3\1	M/11	
GODFREY	Cecelia	18/12/1913	2\3\1	M/11	
GODFREY	George	14/02/1927	2\3\1	M/11	
GODFREY	Alan	02/06/2024	5b\		
GORHAM	Stephen	?/?/1923	2\8\12	Q/12	
GORHAM	Esther	27/05/1947	2\8\12	Q/12	
GORHAM	Albert	03/11/1918	2\8\13	Q/13	
GORHAM	Arthur	03/02/1915	2\8\13	Q/13	
GRANGE	Jane	21/01/1939	4\10\12	S/3	
GREAGSBY	Frances Jane	01/03/1933	3\08\02	R/8	

**CHURCHYARD OF ST PETER & PAUL, SEAL, KENT** Seal graveyard - names & Grid refs

Surname	Christian name(s)	Date of burial	Transcript (record/rc)	Grid reference	Notes
GREAGSBY	William Jeffrey	06/03/1946	3\08\02	R/8	
GREAGSBY	Margaret Eleanor	13/10/1969	3\08\02	R/8	
GREAGSBY	Arthur William			R/8	<i>buried in Belgium</i>
GREEN	Joyce	01/06/2003	5b\02\11	B/15	
GREENFELL	Mabel Blanche	08/10/1936	2\11\3	S/10	
GREENFELL	Charles Molyneux	?	2\11\3	S/10	
GRIMWOOD	Robert George	28/12/1922	2\7\15	P/16	
GRINT	Olive Maria	01/05/1991	5a\24	E/4	
GRINT	Edmund Thomas Charles	01/04/2001	5a\24	E/4	
GROOMBRIDGE	Mary	18/05/1905	2\15\11	W/13	
GROOMBRIDGE	Sarah	31/03/1901	2\15\11	W/13	
GROVES	Charlotte	20/07/1934	3\08\09	Q/5	
GROVES	Frederick Jubilee	18/02/1953	3\18\14	AA/1	
GROVES	Elizabeth	27/03/1975	3\18\14	AA/1	
GURR	Henry	17/05/1934	3\08\07	Q/6	
GURR	Amos	30/05/1945	3\13\07	V/5	
GURR	Ellen	04/02/1948	3\08\07	Q/6	
GURR	Eileen Pamela	30/07/1949	3\15\08	Y/4	
GURR	Donald	01/07/1984	3\08\07	Q/6	
HALE	Stella	07/05/2010	6\2\4	F/14	
HALE	Royden Derek (Dick)	12/08/2015	6\2\4	F/14	
HALL	Helen Ann	16/09/1949	3\15\06	Y/5	
HAMMOND	Richard	01/04/1905		V/6	<i>Died in Austria in 1918</i>
HAMMOND	William Henry	13/09/1945	3\13\04	V/6	
HAMMOND	Rose William	07/01/1948	3\13\04	V/6	
HARDS	Mabel	13/11/1947	3\15\08	X/4	
HARLAND	Joyce	17/10/2013	5a\23	E/4	
HARLAND	Cecil George	01/04/1991	5a\23	E/4	
HARRIS	Frederick George	24/02/1926	3\02\08	L/7	
HARRIS	John Edward	10/12/1947	3\15\07	X/5	
HARRIS	Rose	17/01/1977	3\15\07	X/5	
HARRIS	John William	01/12/1999	3\15\07	X/5	
HARRIS	Rhoda Millicent	07/07/1905	3\15\07	X/5	
HARRISON	Violet Mary	01/10/1991	4\08\04	H/7	
HARRISON	Jack Wallace Tremlett	01/11/2002	4\08\04	H/7	
HARRISON	Peter Derek	15/05/2017	4\10\03	H/5	
HARRISON	Jenny	01/07/2007	4\10\03	H/5	
HARTNUP	Alice Eva	01/03/1987	4\06\11	A/9	
HARTNUP	Leonard Wilfred	01/01/1999	4\06\11	A/9	



**CHURCHYARD OF ST PETER & PAUL, SEAL, KENT**

Seal graveyard - names &amp; Grid refs

Surname	Christian name(s)	Date of burial	Transcript (record/rc)	Grid reference	Notes
HARRIDGE	Harry	14/12/1950	3\17\14	Z/2	
HARTUP	Jabez	29/12/1930	3\06\08	P/8	
HARVEY	Florence Maud	01/04/1942	3\12\06	U/6	
HARVEY	Charles	26/03/1966	3\12\06	U/6	
HARVEY	Florence Ivy	19/04/1991	3\12\06	U/6	
HASKINS	Judith Mary	11/10/2015	5b\4\10	C/16	
HASTINGS	Elizabeth Jessie	01/07/1998	4\10\04	H/5	
HAWKES	Ernest	01/01/1970	4\01\10	B/11	
HAWKES	Frances Faith Austen	01/01/1990	4\01\10	B/11	
HAYES	Vincent Orbell Hayes	21/11/1925	3\01\13	K/5	
HEASMAN	Agnes Rebecca	01/11/1971	4\02\06	D/11	
HEASMAN	Alfred Harry	01/11/1971	4\02\06	D/11	
HEATH	Ronald	04/10/1926	3\02\09	L/6	
HEBERT	Septimus	09/12/1930	3\06\03\04	P/10	
HEBERT	Caroline	04/05/1935	3\06\03\04	P/10	
HEBERT	Constance Elizabeth	02/02/1950	3\06\03\04	P/10	REMOVED 1957
HESTER	Frank	22/09/1954	3\20\15	CC/1	
HICKS	Florence Gertrude	02/10/1939	3\11\04	T/6	
HICKS	Arthur Joseph	22/11/1948	3\11\04	T/6	
HILL	Ann	25/02/2010	5b\03\5	C/17	
HILL	David John	24/12/1959	3\19\04	BB/6	
HILLS	Bessie Sinclair	10/01/1931	3\06\09	P/7	
HILLS	Frank Arthur	15/10/1940	3\11\07	T/5	
HILLS	Amy	03/01/1959	3\11\07	T/5	
HILLS	Cyril	01/03/1993	5a\34	B/5	
HILLS	Frances Sarah	01/03/2002	4\11\07	E/5	
HILLS	Mary Ann	02/09/1932	3\07\14	P/5	
HOBLYN	Reynold Armstrong	01/09/1933	3\08\06	R/7	
HOBLYN	Robert	30/12/1946	3\08\06	R/7	
HOBLYN	Alica Maudlayne	02/12/1963	3\08\06	R/7	
HODDER	Elizabeth Sarah	16/01/1940	3\11\12	T/3	
HODDER	John Charles	07/11/1947	3\11\12	T/3	
HODGES	Emily Laura	?	2\9\3	Q/11	
HODGSON	Frederick	08/07/1929	3\05\01	O/11	
HODGSON	Alison Margaret	22/04/1931	4\07\01	Q/11	
HODGSON	Eleanor Winifred	19/01/1968	3\05\01	O/11	
HOGG	Elizabeth Agnes	09/02/1928	3\04\06	N/8	
HOGG	Norah (Lorah?) Burr	03/12/1930	3\04\06	N/8	
HOGG	Edward James	09/11/1954	3\04\06	N/8	

**CHURCHYARD OF ST PETER & PAUL, SEAL, KENT** Seal graveyard - names & Grid refs

Surname	Christian name(s)	Date of burial	Transcript (record/rc)	Grid reference	Notes
HOGG	Joan Margaret	01/03/1992	4\08\05	E/7	
HOGG	Irene Louisa	01/03/2000	5b\01\17	B/14	
HOGG	Peter	01/06/2000	4\08\05	E/7	
HOLLAND	Gladys Elizabeth	10/08/1933	3\08\04	R/7	
HOLLAND	Edith May	01/01/1972	4\02\09	C/11	
HOLLANDS	William	22/01/1924	3\01\05	L/8	
HOLLANDS	Katie	09/03/1933	3\01\05	L/8	
HOLLANDS	George Reginald	08/08/1945	3\13\05	V/5	
HOLLANDS	Elsie May	03/02/1951	3\17\12	Z/2	
HOLMDEN	John	06/07/1945	3\13\06	V/5	
HOLMDEN	Thomas James	19/11/1946	3\14\05	W/6	
HOLME	John Lawrence Basden	01/06/2001	4\10\09	C/6	
HOLME	Jean Edmyna	01/07/2001	4\10\09	C/6	
HOPE	Annie Ethel	01/01/1970	4\02\02	I/10	
HOPE	William		4\02\02	I/10	
HORLEY	Edward William	26/01/1946	3\13\02	V/7	
HORLEY	Isabella	07/11/1951	3\13\02	V/7	
HORLEY	Dora Isabella	19/04/1991	3\13\02	V/7	
HORNBY	Elizabeth Harriet	27/22/1904	2\14\4	V10	
HORNBY	Henry	22/06/1920	2\14\4	V10	
HORRIDGE	Brian	23/06/2017	5b\5\8	D/16	
HOUSE	Jennifer	18/03/2006	4\03\08	F/9	
HOWCROFT	Leslie Alfred	01/07/1987	4\07\05	F/8	
HOWCROFT	Ivy Gladys	01/04/1996	4\07\05	F/8	
HUCKS	Ivy Ethel	15/10/2010	5b\02\12	C/16	
HUCKS	George Alfred	15/10/2010	5b\02\12	C/16	
HUCKS	George	30/11/1954	3\19\10	BB/3	
HUCKS	Emily Elizabeth	10/05/1967	3\19\10	BB/3	
HUDSON	Guy	05/12/1992	3\08\06	R/7	
HUDSON	George	21/09/2021	5b\4\25	C/13	
HUGHES	Donald Stewart Wilson	17/03/1934	3\03\14	M/4	
HUGHES	Joy Margaret	01/11/1984	4\06\02	I/8	
HUMPHREY	Pamela	01/03/2003	5b\02\10	B/15	
HUSSEY	Harry Percy	01/03/1939	4\10\13	S/3	
HUSSEY	Ethel Jane	25/01/1943	4\10\13	S/3	
HUSSEY	Marion Agnes	23/03/1976	4\10\13	S/3	
HUTCHINGS	Henry Douglas	23/06/1937	4\09\13	R/3	
IMMINK	Carl Gustav	03/04/1966	3\20\07	CC/4	
IMMINK	Florentine	07/07/1997	3\20\07	CC/4	

**CHURCHYARD OF ST PETER & PAUL, SEAL, KENT** Seal graveyard - names & Grid refs

Surname	Christian name(s)	Date of burial	Transcript (record/rc)	Grid reference	Notes
INNES	Mary Anne	08/08/1956	3\14\05	W/6	
INNES	William John	01/09/1986	4\06\08	D/7	
INNES	Alfred	01/12/1994	5a\41	A/5	
INNES	Florence Ada	01/03/2004	5a\41	A/5	
IVERSON	Elsie	01/02/1993	5a\33	C/5	
IVES	Ellen Margaret	08/12/1951	3\17\06	Z/5	
IVES	Laura	05/04/1904	2\3\11	M/14	
IVES	William	07/12/1922	2\3\11	M/14	
JACKMAN	Alfred James	25/10/1955	3\21\14	DD/1	
JAMES	Sarah Ann	21/09/1926	3\03\03	M/8	
JAMES	Clive	26/02/2020	6\2\1	F/13	
JANZ	Beatus	12/01/1928	3\04\04	N/9	
JANZ	Eliza	09/02/1951	3\04\04	N/9	
JAPPE	Mary Ann	22/12/1928	3\04\08	N/7	
JEAL	William Charles	19/08/1930	3\05\09	O/8	
JEAL	Charles	27/05/1950	3\05\09	O/8	
JEFFRIES	Infant son of Capt A.R Jeffer	29/06/1928	3\02\10	L/6	
JENNER	Catherine Cochrane Turnbull	01/07/1991	5a\25	E/4	
JESSUP	Graham Marcus	01/09/2007	5b\03\26	C/13	
JOHNSON	James	29/04/1935	3\08\12	Q/3	
JOHNSON	Ann Elizabeth	17/05/1939	4\10\14	S/3	
JOHNSON	Frederick	27/02/1945	3\13\09	V/4	
JOHNSON	Nellie	01/08/1966	3\13\09	V/4	
JOHNSON	Edith may	28/01/1980	3\08\12	Q/3	
JOHNSON	Robert William	01/10/1985	5a\07	H/4	
JOHNSON	Ada May	01/12/1985	5a\08	H/4	
JOHNSON	Margaret	08/07/2017	4\07\04	F/8	
JOHNSON	Frank William James	01/07/1987	4\07\04	F/8	
JOHNSON	Alice Winifred	01/01/1999	4\10\07	E/6	
JOHNSON	Annie	17/05/1939	3\07\14	P/5	
JOHNSON	Kathleen	17/08/2020	6\3\7	G/15	
JONES	Thomas Cecil	24/08/1945	3\13\01	V/7	
JONES	Sarah Pauline Smith	26/06/1958	3\13\01	V/7	
JONES	Maureen Grace	12/08/2022	5b\6\6	D/16	
JONES-DAVIES	Henry	30/10/1947	3\15\09	X/4	Vicar of Seal 1920-1945
JONES-DAVIES	Margaret Edith	06/04/1964	3\15\09	X/4	
KENNEDY	Alfred James	01/06/1995	4\09\04	G/5	
KENNEDY	Rosina Lilian			G/5	
KENNEDY	Mary (May?) Ethel	10/10/1895	2\17\9	Y/12	

**CHURCHYARD OF ST PETER & PAUL, SEAL, KENT** Seal graveyard - names & Grid refs

Surname	Christian name(s)	Date of burial	Transcript (record/rc)	Grid reference	Notes
KENNETT	Harry	15/03/1958	3\18\06	AA/5	
KENNETT	Elizabeth	17/11/1958	3\18\06	AA/5	
KENNETT	Constance Alice Barbara	01/09/1995	5b\01\01	B/17	
KENNETT	Richard	01/10/2001	5b\01\01	B/17	
KILLON	Elizabeth	05/06/1926	3\02\07	L/7	
KING	Annie Elizabeth	04/12/1925	3\02\06	L/7	
KING	James	12/01/1927	3\02\06	L/7	
KING	Lizzie	06/11/1935	4\09\04	S/7	
KING	Samuel William	12/03/1951	3\17\11	Z/3	
KING	William Stimpson	07/04/1952	4\09\04	S/7	
KING	Sarah Jane	23/11/1960	3\17\11	Z/3	
KING	Muriel Olive	01/09/1974	4\04\01	J/9	
KING	Leslie	22/03/1985	4\09\04	S/7	
KING	Ernest William	26/03/1985	3\17\11	Z/3	
KING	Gladys Florence	01/11/1994	4\09\03	H/5	
KING	Alan Collin	01/10/1998	5b\01\11	B/15	
KING	Samuel Leonard	01/03/2003	4\04\01	J/9	
KNIGHT	Andrew	01/09/1991	5a\28	D/4	
KNIGHT	Peter	01/12/2000	5a\28	D/4	
KNIGHT	William John Southam	21/08/1871	2\21\14	CC/14	
KNOX	Florence Helena	29/04/1995	5a\43	A/5	
LABRUM	Eileen	31/07/1943	3\13\15	V/2	
LACY	Roy	27/03/2024	5b\01\22	B/13	
LACY	Sylvia Elizabeth	01/03/2001	5b\01\22	B/13	
LAMBOURNE	Brenda Maude	01/06/1974	4\03\08	F/9	
LAMPKIN	Dorothy	14/12/1983	5\03	J/4	
LAMPKIN	Albert Harry	13/10/1993	5\03	J/4	
LAMPKIN	Albert Henry	01/10/1993	5a\03	J/4	
LANGRIDGE	Alice	05/10/1935	3\09\02	S/7	
LANGRIDGE	Ernest John	04/12/172	3\09\02	S/7	
LAWRENCE	George	25/02/1983	4\02\07	D/11	
LAWRENCE	Dorothy	01/01/1972	4\02\07	D/11	
LAWRENCE	Sarah Ann	01/01/1918	2\6\6	O/13	
LAWRENCE	Charles	03/12/1938	2\6\6	O/13	
LAWS	Madeline	17/03/2009	4\12\11	A/6	
LAWS	Charles James	01/03/2003	4\12\11	A/6	
LAWS	Anne	19/02/2004	4\12\11	A/6	
LEA	Phillip	11/12/1965	6\3\4	G/14	
LEA	Audrey	03/03/1990	6\3\4	G/14	

**CHURCHYARD OF ST PETER & PAUL, SEAL, KENT**

Seal graveyard - names &amp; Grid refs

Surname	Christian name(s)	Date of burial	Transcript (record/rd)	Grid reference	Notes
LEATHERMAN	Gerald Hubert	03/02/1992	5a\29	D/4	
LEEDS	Stanley	24/05/2013	6\2\10	F/15	Still born child
LEIGH	Elizabeth Ann	06/12/1995	5b\01\02	J/4	
LEIGH	Peter Edwin	29/04/1997	5b\01\02	J/4	
LEROY LEWIS	Diana	16/04/2015	5b\4\7	C/16	
LESLIE	Iris Joan	01/10/1983	4\08\01	J/7	
LINEHAM	Dilys	01/09/1996	4\09\07	D/7	
LINEHAM	John Tony	01/02/2008	4\09\07	D/7	
LINFORTH	Ethel	08/07/2003	5b\02\12	B/15	
LOBB	Walter	01/01/1918	2\2\10	L/16	
LOGAN	Reginald Samuel Trevor	01/06/1990	4\07\11	A/7	
LOGAN	Grace Annie Logan	20/03/1996	4\7\11	A/7	
LOGAN	Grace Annie	01/03/1996	4\07\11	A/7	
LOGAN	Paul	14/06/2014	5b\4\6	C/16	
LONG	Bridget	18/02/1935	3\08\11	Q/4	
LONG	Grace	20/08/1957	3\22\10	EE/3	
LONGHURST	Francis Sarah	17/01/1947	3\14\03	W/7	
LOVEDAY	Alfred Richard	02/10/1940	3\11\08	T/4	
LOVEDAY	Charlotte Amelia	29/01/1946	3\11\08	T/4	
LOVEDEN	Emily May	15/04/1929	3\04\10	N/6	
LOVEDEN	Sydney	08/04/1960	3\04\10	N/6	
LOVEDEN	Joyce Margaret	30/03/1972	3\04\10	N/6	
LOVELOCK	Mary Jane	27/01/1929	3\04\09	N/7	
LOWER	Beatrice Ethel	03/09/1958	3\23\12	ff/2	
LYNDS	Diane	01/01/1989	4\07\09	F/5	
LYNDS	Carol	15/03/1996	4\09\05	F/5	
LYNN	Wilfred	06/12/1994	5a\40	A/5	
LYNN	Valarie Constance	18/07/2002	5a\40	A/5	2002 Ashes?
MAIN	Annie May	?	2\15\1	W/9	
MALLION	Marina	08/01/1937	3\02\13	L/5	
MANN	Valerie June	01/04/1985	4\08\02	I/7	
MARKHAM	David Christopher	01/01/1996	4\09\08	C/7	
MARRIOTT	Marie Winifred	27/07/1949	3\15\09	Y/4	
MARSH	Doris Barbara	01/11/1986	5a\10	H/4	
MARSH	Frederick? Stephen	11/01/1919	2\19\9	AA/13	
MARSH	Mary Ann	08/11/1850	2\19\9	AA/13	Death date from civil record. Not in burial register. May
MARSH ?	Kate Isabel	4/9/1884?	2\18\6	Z/11	Guesswork based on Old Burial Register
MARSHALL	Mary Elsie	01/02/2002	4\11\06	F/5	
MARTIN	Dorothy	17/12/1957	3\18\08	Y/3	

# CHURCHYARD OF ST PETER & PAUL, SEAL, KENT

Seal graveyard - names & Grid refs

Surname	Christian name(s)	Date of burial	Transcript (record/rc)	Grid reference	Notes
MARTIN	Thomas	16/11/1950	3\17\15	Z/2	
MARTIN	Christopher			C/16	
McGHEE	Deirdre	03/01/1949	3\16\12	Y/3	
MCHUGH	Helen Mabel	26/07/1989	5a\20	F/4	stone only, ashes buried elsewhere
MEDCRAFT	George Arthur	22/02/1938	4\10\05	S/6	
MEDCRAFT	David John	01/01/2002	5b\02\05	B/17	
MEDCRAFT	Millie Joyce		4\10\05	S/6	
MEDD	Sybella Frances Irwin	01/06/1993	5a\35	B/5	
MEDD	John Peter		5a\35	B/5	
MILES	Julie Cristel	04/06/1958	3\19\03	BB/6	
MILES	Raymond George	01/07/1992	4\08\06	E/8	
MILES	Rosemary	24/01/2019	5b\5\13	D/15	
MILES	Thomas	21/03/1888	2\9\2	Q/10	
MILLS	Charles William	06/04/1919	2\10\5	R/11	
MILLS	Alice Marion	13/09/1917	2\10\5	R/11	
MILLS	Geoffrey Edward	14/09/1917	2\10\10	R/13	
MILLS	Charles Henry	03/04/1898	2\17\15	Y/15	
MILLS	Louisa Isabella	30/11/1910	2\17\15	Y/15	
MILLS	Violet	?/?/1958	2\17\15	Y/15	
MILTON-THOMPSON	Peter	18/09/2023	6\3\9	G/16	
MITCHESON	Clara Percy	02/02/1950	3\16\04	Y/6	
MITCHISON	Florence Ellen	21/11/1962	3\25\10	HH/3	
MONTAGUE	Robert Leonard	17/04/2003	4\12\10	A/5	
MOORE	Emily	13/01/1939	4\10\10	S/4	
MOORLEN	Bessie (Betsie?)	18/08/1896	6\2\6	F/15	
MOORLEN	Sophia Frances	15/01/1894	6\2\7	F/15	
MOORLEN?	Stephen?	16/12/1860	2\16\16	X/15	
MORGAN	Mary Mason	22/02/1940	3\11\10	T/4	
MORGAN	Dorothy Ethel Burbridge	01/06/1968	4\01\02	I/10	
MORGAN	John	01/09/1980	4\01\02	I/10	
MORLEY	Henry	10/2/1881	2\20\3	BB/10	
MORLEY	Mary Ann	12/05/1890	2\20\3	BB/10	
MORRIS	Frederick George	01/01/1978	4\03\11	A/10	
MORRIS	Margaret Ruth	04/09/2015	4\03\11	A/10	
MORRIS	Annette Winifred Karen	01/12/2002	4\11\11	A/10	
MORRIS	John Frederick	01/06/2003	4\11\11	A/10	
MORRIS	Christopher Charles	01/02/2008	4\03\11	A/10	
MORRIS	Barbara Joan	01/01/1993	5a\31	C/5	
MORRIS	Alan Ralph Oakden	16/11/2014	5a\31	C/5	Former Vicar of Seal

Guesswork based on old Burial Register

**CHURCHYARD OF ST PETER & PAUL, SEAL, KENT**

Seal graveyard - names &amp; Grid refs

<b>Surname</b>	<b>Christian name(s)</b>	<b>Date of burial</b>	<b>Transcript (record/row)</b>	<b>Grid reference</b>	<b>Notes</b>
MORRIS	Alfred	22/04/1913	2\6\1	O/11	
MORRIS	Mary Alice	16/11/1934	2\6\1	O/11	
MOUNTFORD	Edith Isabella	06/12/1938	4\10\09	S/5	
MOUNTFORD	George Frederick			S/5	
MOWBRAY	Alice Mary	14/06/1946	3\14\08	W/4	
MOYCE	Emma Helen	09/10/1908	2\11\7	S/13	
MOYCE	John	19/06/1903	2\11\7	S/13	
MOYCE	Fanny	09/04/1927	2\11\7	S/13	
MOYCE	Henry	11/11/1910	2\11\7	S/13	
MOYSE	William Saker	03/12/1925	3\01\10	K/6	
MURPHY	Edna Muriel	01/04/2002	5b\02\07	B/16	
MUSCHAMP	Percy Allen Hunter-Combe	19/03/1959	3\23\10	FF/3	
NASH	Walter Ernest	27/01/1947	3\14\02	W/7	
NEAME	Isabelle Alice	09/09/1999	3\18\01	AA/7	
NEAVE	Wilfred Harry	06/03/1937	4\09\12	R/4	
NEAVE	Winifred	23/01/1997	4\09\12	R/4	
NEEDHAM	Alfred	27/05/1933	3\08\03	R/8	
NEEDHAM	Laura Rhoda	12/02/1947	3\08\03	R/8	
NEEDHAM	Reginald Alfred			R/8	Buried in Calais
NEEDHAM	Henrietta Blanche	23/08/1949	3\08\03	R/8	
NEVILLE	Daniel	01/12/2005	5b\02\21	B/13	
NEVILLE	Eleanor Elizabeth	07/09/1886	2\14\5	V/11	
NEVILLE	Arthur	20/04/1090	2\14\5	V/11	
NEVILLE	Maria	19/07/1909	2\14\5	V/11	
NEWELL	Alfred	24/11/1932	3\05\13	O/6	
NORBURN	Edith Emma	01/02/1946	3\14\15	W/2	
NORBURN	Sidney Herbert	28/07/1948	3\14\15	W/2	
NORMAN	Vincent St John	03/07/1939	3\11\14	T/2	
NORTON	Clara	11/05/1954	3\18\09	AA/3	
NORTON	Walter John	15/09/1987	3\18\09	AA/3	
NORTON	Ada	29/04/1993	3\18\09	AA/3	
O'CONNOR	Pearl Kathleen	08/10/2017	5b\01\10	B/15	
O'CONNOR	John William	20/06/1998	5b\01\10	B/15	
ORR-EWING	Hugh Eric Douglas	11/06/1964	3\23\10	FF/3	
ORR-EWING	Muriel	11/10/1994	3\23\10	FF/3	
OSBORNE	Jonathan	29/07/1881	2\20\2	BB/10	
OSBORNE	Maria	16/03/1886	2\20\2	BB/10	
OWEN	Thomas	05/02/1935	3\02\01	L/9	
PARKER	Norman Frank	01/01/2004	4\12\08	C/5	

**CHURCHYARD OF ST PETER & PAUL, SEAL, KENT** Seal graveyard - names & Grid refs

Surname	Christian name(s)	Date of burial	Transcript (record/rc)	Grid reference	Notes
PARSON	Walter	23/08/1941	3\12\10	U/4	
PATTENDEN	Harriet	17/07/1906	2\11\6	S/12	
PATTENDEN	Thomas	22/02/1908	2\11\6	S/12	
PATTENDEN	Harriet (daughter)	09/08/1911	2\11\6	S/12	
PATTENDEN	Horace John	02/02/1911	2\19\5	AA/11	
PATTENDEN	E Agnes	04/03/1947	2\19\5	AA/11	
PAUL	Lucy Evelyn	26/10/1905	2\12\1	T/9	
PEACH	Helen Maud	29/12/1959	3\19\09	BB/3	
PEACOCK	Mabel	07/02/1948	3\15\05	X/5	
PEACOCK	Charlotte May	123/05/94	4\05\03	H/10	
PEACOCK	George Thomas	01/10/1980	4\05\03	H/10	
PENN	William Thomas Prosser	08/12/1927	3\04\03	N/9	
PENN	Charlotte May	01/05/1994	4\05\03	N/9	
PENN	Eleanor Georgina	12/12/1927	3\04\03	N/9	
PENNELLS	Henry Donovan Angus	07/04/1993	4\08\08	D/8	
PIDGLEY	Winifred may	01/08/1998	4\10\05	G/6	
PIGGOTT	Robert	17/05/1925	3\02\04	L/8	
PIGGOTT	Emma	07/01/1927	3\02\04	L/8	
PIGGOTT	Thomas	09/09/1925	3\02\05	L/8	
POLAND	Raymond Denham	17/10/1947	3\15\15	Y/2	
POLAND	Jean Stewart	21/01/1977	3\15\15	Y/2	
POLAND	John Roberts	09/03/1961	2\2\8	L/15	
POLAND	Karin	07/12/1973	2\2\8	L/15	
POLAND	Richard Bengt	03/03/1996	2\2\8	L/15	
POLAND	Lydia	01/01/1918	2\2\8	L/15	
POOLE	Albert John	21/01/1939	3\11\01	T/8	
PORRITT	Robert John Rudolf	02/11/04	5b/2/15	B/14	
PORTLOCK	Leonora May	27/10/1964	3\26\12	II/3	
PORTLOCK	William	11/03/1968	3\26\12	II/3	
POTTER	William Isaiiah	06/12/1938	4\10\08	S/5	
PRATT	Theresa Sarah	?/?/1824	2\17\14	Y/14	Dau of 2nd Marquis Camden
PRESS	Frederick	06/12/1909	2\12\4	T/10	
PRESS	Ellen	05/11/1908	2\12\4	T/10	
PRICE	Charles Henry	17/06/1943	3\12\04	U/6	
PRICE	Richard Edward	02/11/1951	3\12\04	U/6	
PRICE	Thomas Allen	19/04/1991	3\12\04	U/6	
PRIESTLEY	John Fitzgerald	01/07/1981	4\04\08	D/10	
PUCKNELL	Harriett	27/01/1937	3\04\12	N/5	
PUCKNELL	David John	23/07/1929	3\04\12	N/5	



**CHURCHYARD OF ST PETER & PAUL, SEAL, KENT** Seal graveyard - names & Grid refs

Surname	Christian name(s)	Date of burial	Transcript (record/rc)	Grid reference	Notes
PUFFETTE	Haydn	02/09/2017	5b\5\7	D\16	
PUGH	Paule	13/05/1930	3\05\06	O/9	
PUXLEY	John Frank	18/04/1946	3\14\11	W/3	
PUXLEY	Edith May	11/05/1981	3\14\11	W/3	
QUINLAN	Charles Patrick	13/01/1971	4\02\05	F\11	
QUINLAW	Winifred Agnes	01/11/1987	5a\16	G/4	
QUINNELL	Julia Lucy	19/07/1939	3\11\03	T/7	
QUINNELL	Alice	30/03/1945	3\13\08	V/4	
QUINNELL	Elisha	20/10/1945	3\13\08	V/4	
QUITTENDEN	Alice	12/09/2012		U/7	
RABBITTS	Jennifer	01/08/2000	5b\01\20	B\13	
RAGGE	Henrietta	11/11/1931	3\07\05	Q/9	
RAGGE	Russell	15/08/1936	3\07\05	Q/9	
RAIKES	Mona Penelope	05/05/1938	3\02\17	L/5	
RAINEY	Natasha	14/07/2023	6\3\8	G\16	
RAISEN	John Arthur	28/01/2013	5b\02\26	B\13	
RAISEN	Daphne	08/07/2007	5b\02\26	B\13	
RAMPTON	Doris Eileen	01/01/2003	5b\02\09	B\16	
RANCE	Louise	08/02/1924	3\01\06	K/7	
RANDALL	Mary Ann	02/06/1873	6\2\12	F\16	
RANGER	Gertrude mary	01/12/1982	4\05\04	H\10	
READ	John Lynton	date unknown		Q\6	1 at Sea. On memorial with Dora May Sutton
READ	Doris Marian	01/05/2000	5a\43	A\5	
REDGROVE	Edward James	11/03/1949	3\15\11	Y\3	
REDGROVE	Margaret	13/04/1951	3\15\11	Y\3	
REEVES	Margery Elmer	22/10/2021		B\13	
REEVES	Elizabeth	14/09/1931	3\07\04	Q\10	
REEVES	Jessie	25/04/1939	3\07\04	Q\10	
REEVES	Frances Sarah	09/04/1946	3\14\12	W\3	
REEVES	George Charles			Q\10	BURIED IN S. AFRICA
REEVES	Reginald Albert	01/07/2000	5b\01\18	B\13	
REGAN	Gordon Francis	01/03/2024	5b\01\13	B\15	
REGAN	Ruth Elizabeth	01/05/1999	5b\01\13	B\15	
REID	Andrew Henry	12/02/1956	3\21\13	DD\2	
RENDELL	Walter	11/01/1927	3\03\06	M\7	
RENDELL	Jemima	28/06/1951	3\03\06	M\7	
REYNOLDS	Richard John	03/10/1930	3\06\06	P\9	
REYNOLDS	Jane	31/03/1931	3\06\06	P\9	
RICHARDSON	Mabel Dorothy	21/09/1977	3\25\12	HH\2	

# CHURCHYARD OF ST PETER & PAUL, SEAL, KENT

Seal graveyard - names & Grid refs

Surname	Christian name(s)	Date of burial	Transcript (record/reference)	Grid reference	Notes
RICHARDSON	Elizabeth Emma	01/12/1986	4\07\03	H/8	
RICHARDSON	Edward James	16/12/1988	4\07\03	H/8	
RICHARDSON	Edward James	01/12/1988	4\07\03	H/8	
ROBERTS	John Michael Adair	16/08/1929	3\06\01\02	P/11	
ROBERTS	Frederick Morriss	12/01/1957	3\06\01\02	P/11	
ROBERTS	Margaret Ann Laird	08/06/1966	3\06\01\02	P/11	
ROBERTS	Gladys	29/11/1939	3\11\13	T/3	
ROBERTS	Herbert Leonard	27/12/1897	2\14\6	V/11	Possibly son of Solomon and Ellen Roberts; grandchild
ROBERTS	Ellen	22/01/1907	2\14\10	V/13	
ROBERTS	Solomon	26/04/1918	2\14\10	V/13	
ROOKE	Maria	24/04/1958	3\18\07	AA/4	
ROSE	Dorothy	20/03/1974	4\3\5	H/9	
ROSE	Dorothy	01/03/1974	4\03\05	H/10	
RUSH	Sebastian	11/01/2002	6\2\1	F/13	Still born child
RUSSELL	Richard	19/01/1939	4\10\11	S/4	
RUSSELL	Leonard Douglas	01/02/1974	4\03\03	I/9	
RUSSELL	Alice Maud	01/02/1974	4\03\04	H/9	
RUSSELL	Ernest Reginald	01/01/1978	4\03\04	H/9	
RUSSELL	Bridget Anna Laird	19/12/1980	3\06\01\02	P/11	& Margaret Laird Doe - inscription only
RUSSELL	Edith Cicely	01/06/1999	4\03\03	I/9	
RUSSELL	Brian Douglas	01/12/2003	4\11\10	B/6	
RUSSELL-VICK	Zinnia Mary	04/12/2023	5b\6\9	D/16	
RYDER	George	15/07/1924	3\01\07	K/7	
SAKER	Ellen	09/10/1924	3\01\10	K/6	
SALE	James Ernest	23/06/1951	3\17\08	Z/4	
SALES	Amos	08/12/1926	3\03\04	M/8	
SALES	Eliza Amelia	03/12/1933	3\03\04	M/8	
SALES	Hannah	11/05/1938	4\10\06	S/6	
SALES	James Amos	30/09/1941	3\12\09	U/4	
SALES	John	10/11/1942	4\10\06	S/6	
SAMSON	Ellen	01/07/1986	4\06\06	I/9	
SAMSON	Eric George	01/01/1980	4\05\02	I/9	
SANDWELL	Dorothy Phyllis	01/09/1973	4\03\02	I/9	
SANDWELL	Lionel George	01/09/1973	4\03\02	I/9	
SANGER	Edward Percy	16/02/1924	3\02\01	L/9	
SANGER	Irene	10/01/1964	3\02\01	L/9	
SAUNDERS	Sylvia	24/04/2010	5b\03\10	C/16	
SAUNDERS	John Ernest	27/05/1904	2\7\3	P/10	
SAUNDERS	Richard	13/07/1912	2\7\3	P/10	

**CHURCHYARD OF ST PETER & PAUL, SEAL, KENT** Seal graveyard - names & Grid refs

Surname	Christian name(s)	Date of burial	Transcript (record/rc)	Grid reference	Notes
SAUNDERS	Isabel	07/03/1908	2\7\3	P/10	
SCOTT	Ethel Kate	04/10/1948	3\15\14	Y/2	
SEABROOKE	Roger Michael	22/07/1933	3\02\12	L/6	
SEARLE	Ian Oscar	21/08/2005	5b\02\20	B/14	
SEELEY	Howard Kenneth Frederick	31/01/1938	3\10\04	S/6	
SELLENS	Frederick George	19/06/1962	3\25\07	HH/5	
SELLENS	Florence	17/10/1977	3\25\07	HH/5	
SHARP	Doreen Frances	01/01/1986	5a\09	H/4	
SHARP	Frederick Stephen	01/09/1986	5a\09	H/4	
SHARP	Anthony	18/10/2006	5a\09	H/4	
SHAUL	John Reginald	06/09/1963	3\26\12	II/3	
SHAW	Henry Heaton	07/04/1936	4\09\09	R/5	
SHAW	Doreen (DEE) aka Smithson	01/11/1990	4\01\11	A/11	
SHELLEY	George	01/04/1905	3\23\14	FF/1	burial to George Shelley, killed in France, no known gra
SHELLEY	Annie	04/11/1959	3\23\14	FF/1	
SHELLEY	Ernest Arthur	30/04/1958	3\23\14	FF/1	
SHEPPARD	James	05/11/1927	3\03\13	M/4	
SHEPPARD	Thomas Henry James	21/01/1958	3\18\07	AA/4	
SHIELDS	Kathleen Edith Alice	07/03/1956	3\21\12	DD/2	
SIBLEY	Louisa Elizabeth	01/06/1988	4\07\07	C/8	
SIBLEY	William Alexander	27/05/1992	4\07\07	C/8	
SILCOCK	William Dale	26/09/1983	5\01	J/4	
SIMMONS	Sue	?	5b\3\9	C/16	Stone only, ashes buried elsewhere
SIMMONS	George	09/10/1924	3\01\08	K/7	
SIMMONS	Edward	12/04/1932	3\05\14	J/4	
SIMMONS	Ruth	28/11/1935	4\09\05	R/6	
SIMMONS	Elizabeth	17/12/1937	3\05\14	O/5	
SIMPSON	Hilda Marion	30/09/1946	3\14\06	W/5	
SIMPSON	Grace		4\09\05	R/6	
SIMPSON	John Edward Lewis	07/04/1953	3\14\06	W/5	
SINDALL	Elizabeth	20/10/2022	5b\6\6	D/16	
SKEER	George Richard	01/12/1975	4\03\09	D/9	
SKELT	Benjamin	21/07/1923	3\01\02	L/9	
SKINNER	George	25/03/1927	3\03\08	M/7	
SKINNER	Evelyn May	21/01/1977	3\03\08	M/7	
SKINNER	Winifred Rose	01/11/1982	4\04\10	B/10	
SKINNER	Vera	01/11/2004	4\12\06	E/5	
SMITH	Frank	30/06/1925	3\01\12	K/5	
SMITH	Mary Ann	05/06/1926	3\03\02	M/9	

**CHURCHYARD OF ST PETER & PAUL, SEAL, KENT** Seal graveyard - names & Grid refs

Surname	Christian name(s)	Date of burial	Transcript/rc (record/rc)	Grid reference	Notes
SMITH	Charles William	27/07/1931	3\03\02	M/9	
SMITH	Rosa	01/10/1956	3\22\14	EE/1	
SMITH	Ernest Harold	14/02/1958	3\03\02	M/9	
SMITH	Sydney	24/03/1964	3\22\14	EE/1	
SMITH	Ethel Dorothy	17/08/1966	3\06\05	P/9	
SMITH	Beatrice Mary	11/10/1966	3\06\05	P/9	
SMITH	Phoebe Edith	04/05/1968	3\03\02	M/9	
SMITH	Evelyn Joan	01/04/1969	4\01\09	B/11	
SMITH	Collin Peter	01/08/1986	4\06\07	B/11	
SMITH	Ronald Malcolm	01/03/1989	4\07\10	B/7	
SMITH	Mona Pretoria	01/11/1997	5b\01\07	B/16	
SMITH	Bertie	May 1892	3\03\02	M9	
SMITH	Mary Moss?	12/07/1915	2\6\3	O/12	
SMITH	Helena?	25/09/1930	2\6\4	O/12	no record in burial register
SMITH	Sarah Harriet	?/03/1910	2\9\4	O/12	
SMITH	Sarah Harriet	11/03/1910	2\10\14	R/15	
SMITH	James	26/08/1915	2\10\14	R/15	
SMITH	Charles	22/03/1932	2\6\3	O/12	
SMITHER	Gladys Mary	01/12/1997	5b\01\09	B/16	
SMITHER	George Farrington	04/05/1964	3\26\10	II/4	
SNEWIN	Elizabeth Mary	15/12/1954	3\20\13	CC/2	
SNEWIN	George	15/10/1963	3\20\13	CC/2	
SOUTHY	Rhoda	16/09/2020	5b\02\22	B/13	
SOUTHY	Alec	26/05/2006	5b\02\22	B/13	
SPARROW	Richard Stephen	15/07/1948	3\15\01	X/7	
SPARROW	Edith	05/06/1967	3\15\01	X/7	
SPARROW	Glenis	20/10/2016	6\3\5	G/15	
STANTON	Anthony Nathaniel, Sir	01/11/1988	4\07\01	J/8	
STANTON	, Lady		4\07\01	J/8	
STARLING	Lorna	13/11/2015	5b\4\11	C/15	
STEADMAN	William	10/03/1941	3\12\13	U/3	
STENT	Edgar William George	11/06/2011	5b\03\11	C/16	
STENT	Edna Mary	28/08/2010	5b\03\11	C/15	
STEVENS	Amanda Louise Margitta	01/02/2000	4\10\08	D/6	
STEVENS	Walter John	01/08/2001	4\10\11	A/7	
STONE	Elizabeth	26/08/1887	6\2\11	F/16	
STONESTREET	Mary Ann	12/08/1954	3\19\14	BB/1	
STORIE-PUGH	Peter	20/10/2011	3\05\2006	O/9	
STRANGE	Frank	26/08/1955	3\04\05	N/9	

**CHURCHYARD OF ST PETER & PAUL, SEAL, KENT**

Seal graveyard - names &amp; Grid refs

<b>Surname</b>	<b>Christian name(s)</b>	<b>Date of burial</b>	<b>Transcript/ rd</b>	<b>Grid reference</b>	<b>Notes</b>
STUBBS	John	06/01/1905	2\12\9	T/12	
STUBBS	Edward	07/09/1933	2\12\9	T/12	
STUBBS	Sophie	04/12/1944	2\12\9	T/12	
STYLES	Mark Alexander	14/03/1951	3\17\10	Z/4	
STYLES	Ethel may	10/09/1955	3\17\10	Z/4	
SUMMERS	Alma Kathleen	06/09/1982	2009	C/10	
SUTTON	Kate May	22/06/1929	3\04\11	N/6	
SUTTON	Harry	09/01/1933	3\04\11	N/6	
SUTTON	Dora May	09/06/1934	3\08\08	Q/6	
SUTTON	Daisy May	03/10/1934	3\08\10	Q/5	
SUTTON	George	01/10/1937	3\08\08	Q/6	
SUTTON	Emma	20/03/1941	3\08\08	Q/6	
SUTTON	Ann Elizabeth	10/01/1948	3\15\06	X/5	
SUTTON	Alma Kathleen	01/09/1982	4\04\09	C/10	
SUTTON	Alan Edward	02/10/1956	3\15\06	W/6	
SUTTON	Mary Josephine	13/05/2023	5b\6\7	D/16	
SWEET	Martha Ann	14/01/1947	3\14\04	W/6	
SWEET	James	01/12/1962	3\14\04	W/6	
SWIFT	Elizabeth	24/04/1927	3\03\09	m/6	
SWIFT	William	06/02/1885	2\14\6	V/11	
SWIFT	Ann	06/03/1896	2\14\6	V/11	
TAMAN	Edith Emily	10/04/1880	2\15\3	W/10	
TAMAN	Ethel Annie	07/12/1893	2\15\3	W/10	
TAMAN	Ethel Emily	05/08/1892	2\15\3	W/10	
TAPLEY	Anna St Clair	19/081907	2\14\13	V/14	
TAPLEY	William	14/08/1881	2\14\13	V/14	
TARRY	Edwin Robson	07/02/2019	4.12.05	G/5	
TARRY	Jasmine	21/12/2006	4.12.05	G/5	
TAYLOR	Emily Jane	18/04/1931	3\07\07	Q/8	
TAYLOR	Valentine Osborne	07/01/1933	3\04\13	N/5	
TAYLOR	Ellen	14/03/1936	4\09\06	R/6	
TAYLOR	Arch	14/03/1936	4\09\07	R/5	
TAYLOR	Robert Emery	31/05/1955	3\20\11	CC/3	
TAYLOR	Albert	16/02/1957	3\22\13	EE/2	
TAYLOR	David Conroy	30/08/1958	3\23\13	FF/2	
TAYLOR	Mabel Ellen	02/11/1958	3\23\13	FF/2	
TAYLOR	Christopher James Emery	07/09/1959	3\18\02	AA/7	
TAYLOR	Emily Elizabeth	31/10/1970	3\04\13	N/5	
TAYLOR	Florine Elizabeth	03/12/1973	3\20\11	CC/3	

# CHURCHYARD OF ST PETER & PAUL, SEAL, KENT

Seal graveyard - names & Grid refs

Surname	Christian name(s)	Date of burial	Transcript (record/rc)	Grid reference	Notes
TAYLOR	Ronald Sydney	01/06/1978	4\04\06	F/9	
TAYLOR	Sidney Harry	01/01/1983	4\05\06	F/10	
TAYLOR	Caroline Amy	10/04/1992	4\05\06	F/10	
TAYLOR	Dennis Banfield	17/08/2015	5b\4\8	C/16	
TAYLOR	Betty August	17/08/2015	5b\4\8	C/16	
TESTER	Charlotte	24/05/1894	2\15\4	W/10	
TESTER	Ebenezer	28/10/1922	2\15\4	W/10	
THOMAS	John	21/01/1932	3\07\09	P/7	
THOMAS	Marguerite	19/09/1964	3\25\13	HH/1	
THOMAS	Sidney	01/11/1986	4\06\10	b/9	
THOMPSON	Fanny	28/01/1928	3\04\05	N/9	
THOMPSON	George	09/03/1991	5\04	J/4	
TOWER	Mary	10/12/1945	3\13\03	V/6	
TOWNSEND	Minnie Selena	22/03/1954	3\18\11	AA/2	
TRIGGS	Edward Donald	01/04/1986	4\06\05	G/9	
TRIGGS	Josephine Kathleen	01/07/2000	4\06\05	G/9	
TRIVASS	Simon John	01/08/1991	5a\27	D/4	
TUBBY	William Edward	17/02/1961	3\24\10	GG/3	
TUCKER	Phyllis Evelyn	01/10/1998	4\10\06	F/6	
TUCKER	Dennis Arthur	01/06/2006	5b\02\22	B/13	
TUCKER	Ethel May (Maisie)	01/06/2006	5b\02\22	B/13	
TUCKER	Denise Aileen (Babs)	01/06/2006	5b\02\22	B/13	
TUNMORE	Gladys Maud	01/08/2001	5b\02\03	B/17	
TURNER	Bernard Adrian	01/05/1932	3\02\11	L/6	
TUTT	Alfred James	24/06/1996	4\9\6	E/5	
TUTT	Joan	02/01/2009	4\9\6	E/5	
TYE	John	27/01/1927	3\03\10	M/6	
TYE	Eliza	16/01/1930	3\06\11	P/7	
TYE	Eleanor	07/02/1931	3\03\10	M/6	
TYE	Edwin	13/01/1938	3\06\11	P/7	
TYE	Ellen	28/12/1944	3\06\11	P/7	
TYE	Ellen	02/05/1942	3\12\05	U/6	
TYE	Annie	prob 1930s		L/17	Daughter of Eliza and John Tye
UNDERWOOD	George Adam	22/08/1950	3\16\01	Y/7	
UNDERWOOD	William George Richard	09/10/1954	3\19\12	BB/2	
VICK	Godfrey Russell, Sir	02/10/1958	3\24\15	GG/1	
VICK	Cyril Hampton	16/07/1977	3\24\15	GG/1	
VICK	Marjorie Hampton	07/06/1985	3\24\15	GG/1	
VICK	Clive Compston Russell	10/11/1990	3\24\15	GG/1	

**CHURCHYARD OF ST PETER & PAUL, SEAL, KENT**

Seal graveyard - names &amp; Grid refs

<b>Surname</b>	<b>Christian name(s)</b>	<b>Date of burial</b>	<b>Transcript (record/rd)</b>	<b>Grid reference</b>	<b>Notes</b>
VOWLER	Sidney Nicholson	12/08/1927	3\04\01	N/10	
WAFORD	Willy Igette	09/04/1948	3\15\03	X/6	
WAFORD	Vera	17/08/1981	3\15\03	X/6	
WAGHORNE	Mary	20/11/1924	3\01\09	K/6	
WAINWRIGHT	George	05/12/1911	2\11\2	S/10	
WAITE	Fiona Temple	06/01/2020	6\3\6	G/15	
WAITE	Simon	11/08/2022	6\3\6	G/15	
WALKER	Robert Kelsall	01/09/1966	4\01\04	H/10	
WALKER	Coral Woodbine	01/11/1970	4\01\04	H/10	
WALKER	Mary	31/12/1878	2\20\6	BB/12	
WALKLING	James Amos Alfred	01/06/1993	4\08\09	C/8	
WARREN	Hilda Emily	21/03/1936	4\09\08	R/5	
WARREN	Walter Joseph	27/11/1970	4\09\08	R/5	
WARREN	Christina	06/12/1909	2\12\5	T/10	
WARREN	George	11/08/1916	2\12\5	T/10	
WATERMAN	Ivy Elizabeth	15/12/1928	3\04\07	N/8	
WATERS	John	16/09/1937	3\02\14	L/5	
WATKINS	Annelia	16/08/1930	3\05\08	O/8	
WAY	Hilda Mary	01/05/1985	5a\06	H/4	
WAY	William Charles	18/09/2006	5b\02\24	B/13	
WAY	Lynda Rosemary	23/01/2020	5b\5\15	D/15	
WAY	Mary Jane	20/07/1914	2\6\1	O/11	
WAY	William	?	2\6\2	O/11	
WEAVER	Lancelot Bargrave	01/03/1987	5a\17	G/4	
WEAVER	Esther Sarah Bargrave	13/03/1987	5a\17	G/4	
WEBB	Ethel Marion	01/03/1924	3\02\02	L/9	
WEBB	Beatrice	08/02/1947	3\15\11	X/3	
WEBB	Ernest Robert	09/12/1950	3\15\11	X/3	
WEBB	William James	20/11/1954	3\19\11	BB/2	
WEBB	Violet Nancy May	11/02/2013	5b\03\18	C/14	
WEBB	(George) Thomas	22/06/1922	2\8\11	Q/12	
WEBB	Fanny	14/14/1890	2\14\1	V/9	
WEBB	Robert	15/01/1907	2\14\1	V/9	
WEBB	Harriet	04/01/1897	2\16\12	X/14	
WEBSTER	Martha Ann	18/09/1959	3\19\11	BB/2	
WEBSTER	Geoffrey Robson	01/02/1975	4\04\04	H/9	
WEBSTER	Jacqueline Russell	17/12/2007	4\04\04	H/9	
WEEKS	Dorothy Ann	01/03/1986	4\06\04	G/8	
WELSH	Frances	17/05/2017	5b\5\6	D/16	

# CHURCHYARD OF ST PETER & PAUL, SEAL, KENT

Seal graveyard - names & Grid refs

Surname	Christian name(s)	Date of burial	Transcript (record/rc)	Grid reference	Notes
WELSH	Charles Ronald	24/06/2022	5b\5\6	D/16	
WERGAN	Shirley	22/04/2018	5b\5\9	D/16	
WEST	Emily	26/08/1942	3\12\03	U/7	
WEST	Beatrice	17/02/1960	3\24\12	GG/2	
WEST	Elizabeth Ann	13/06/1943	3\12\03	U/7	
WESTMORE	Charles Herbert	14/01/1952	3\17\04	Z/6	
WESTMORE	George Thompson	09/03/1991	5\04	J/4	
WESTMORE	Dorothy Annie	09/09/1974	3\17\04	Z/6	
WESTMORE	George	01/06/1984	5a\04	J/4	
WESTMORE	Rose Lilian	15/08/1984	5\04	J/4	Ashes. Removed to Wales 1990
WHEELER	Edward Albert Augustine	03/07/1952	3\17\03	Z/6	
WHEELER	Annie	07/03/1958	3\17\03	Z/6	
WHITE	Frederick Joseph	01/08/1972	4\02\11	A/11	
WHITE	Michael David	01/07/1976	4\04\02	I/9	
WHITE	Joy Ellen	01/05/1978	4\04\05	G/9	
WHITE	Anthony Michael	01/10/2007	4\04\02	I/9	
WHITE	Amelia	01/05/2004	5b\02\14	B/15	
WHITEMAN	Albert Henry	05/08/1954	3\19\15	BB/1	
WHITEMAN	Daisy May	11/10/1977	3\19\15	BB/1	
WICKENDEN	John	23/12/1926	3\04\05	M/8	
WICKENDEN	Thomas William	24/01/1951	3\17\13	Z/2	
WICKENS	Walter	29/10/1962	3\20\10	CC/3	
WICKENS	Annie	20/04/1959	3\20\10	CC/3	
WIGHTMAN	Margaret	01/07/1997	5b\01\06	B/16	
WILKIN	Derek Alan	15/08/1944	3\13\12	V/3	
WILKINSON	Clifford Edward	01/04/2002	4\11\08	D/6	
WILKINSON	Phyllis Gretl	30/11/1997	4\11\08	D/6	
WILLIAMS	Edwin	15/08/1940	3\12\11	U/4	
WILLIAMS	Kate Harriet	19/03/1946	3\12\11	U/4	
WILLIAMS	Catherine Isobel Picton	01/12/1982	4\05\05	F/10	
WILLIAMS	Isobel Mary	20/09/2015	5b\4\9	C/16	
WILLIAMS	W.	20/05/1915	2\5\2	N/11	War Grave
WILLMORE	Mair Eluned	16/06/2014	4\05\05	B/5	
WILLMORE	Eric Laurence	01/07/1993	5a\37	B/5	
WILTSHIRE	Peter E	03/10/2007	5b\03\25	C/13	
WILTSHIRE	Peter E.	01/10/2007	5b\03\25	C/13	
WINDALL	Roy Sidney	12/10/2016	5b\5\4	D/17	
WINDEBANK	June Irene	26/01/2013	5b\03\17	C/14	
WINDEBANK	Peter Thomas	26/01/2013	5b\03\17	C/14	



**CHURCHYARD OF ST PETER & PAUL, SEAL, KENT** Seal graveyard - names & Grid refs

Surname	Christian name(s)	Date of burial	Transcript (record/rc)	Grid reference	Notes
WOOD	Charles Bearmore	30/06/1923	3\01\03	L/9	
WOOD	Ruth	20/04/1948	3\15\02	X/7	
WOOD	Frederick Charles	01/08/2002	4\11\09	C/6	
WOOD	Maria Foster	16/12/1916	2\15\14	W/14	
WOODHAMS	James Henry	29/05/1930	3\05\07	O/9	
WOODHAMS	Henry John	29/05/1930	3\05\07	O/9	
WOODHAMS	Miriam Elizabeth	03/04/1948	3\15\04	X/7	
WOODHAMS	Harry	20/01/1951	3\15\04	X/7	
WOODHAMS	Frank	08/01/1975	3\15\04	X/7	
WOODJETTS	Ronald Albert	20/04/1995	5b\11\4	B/17	
WOODJETTS	Ronald Albert	01/04/1996	5b\01\04	B/17	
WOODWARD	Elizabeth	?	2\8\14	Q15	
WOODWARD	Frederick	?	2\8\14	Q15	
WOODWARD	Alfred	19/02/1917	2\8\14	Q/15	
WOODWARD	Mary	09/01/1964	2\8\14	Q/15	
WOOLEY	George Bernard	05/07/1969	4\01\01	J/10	Ashes Unmarked
WOOLEY	Vera Ethel	27/04/1976	4\01\01	J/10	Unmarked
WYATT	Buster?	?/?/1983	2\19\1	AA/9	Stone seat in memoriam. Not in burial register
WYATT	Joan	?/?/1995	2\19\1	AA/9	Stone seat in memoriam. Not in burial register
YARDLEY	Constance Evelyn	03/04/2017	5b\5\4	D/17	
YATES	Edward	?/?/1897	2\17\12	Y/13	
YOUNG	Robert (Bob) Ernest	02/12/2012	5b\03\16	C/14	
YOUNG	George Bernard	05/07/1969	4\01\01	J/10	
YOUNG	Vera Ethel	27/04/1976	4\01\01	J/10	
YOUNG	Alfred	08/02/1943	3\12\02	U/7	
YOUNG	Flora	02/01/1957	3\12\02	U/7	
YOUNG	Susan	31/01/1892	2\3\16	M/17	
YOUNG	Charles Sear	13/01/1924	2\15\8	W/12	
YOUNG	Jane	21/01/1897	2\15\8	W/12	
YOUNG	Dawn Mary	23/01/2015	5b\03\16	C/14	



# OLD GRAVES IN FRONT OF SEAL CHURCH

This record includes graves from the 1700s to the late 19<sup>th</sup> Century, and was recorded by Leland Duncan in 1921. A sketch map with each grave's location can be found on the ~~map overleaf~~. Grid references for these graves have not yet been recorded, but the sketch map should provide enough guidance to locate them.

<https://www.kentarchaeology.org.uk/research/monumental-inscriptions/llduncan>

## Index of Names

### Names Index

I. A., M. A. 54	CRUTCH 17	KNIGHT 249	SKELTON 291
ADES 215	CURTIS 18, 19, 20	Langcake 332	SKINNER
AINSWORTH 167	DANE 160	LANGFORD 319	191,192,194,195
AKEHURST 216	DANN 282	LINN 72, 73	SLAUGHTER 42, 205
ALLINGHAM 320	DARWIN 218	LIPSCOMB 103	SMART 266
ANDREWS 250	DAVIES 334	MACDONALD 339	SMITH 283, 326-329
ARROW 40	DAVISON 343	MacKINDER 70, 71	SPENCER 262
ARTHERFOLD 80	DAW 181, 182	Macleod 341	St Clair 341, 342
ASHBY 230, 291	DAY 134, 135	MAIR 288	STAMMERS 289
ATHERFOLD 81-83, 99,	DOMINEY 311	MANDY 284-286	STANDEN 250
111, 165, 166	DURANCE 142	MARCHANT 106, 108,	STAPLES 11
AVIS 180	DURRANCE	125	STAPLEY 124
BAITEN 177, 178	145DYSON 86	MASTERS 88-94, 321,	STEER 159, 160
BALDWIN 266	EAL 241,242	322	STEVENS 48
BANKIN 21, 79, 271	EDLOW 26, 28	MATTHEWS 105, 106,	STEWARD 299-300
	ELFORD 220	109, 110	STILL 292
BARHAM 314	ELLIS 278, 279	MAYNARD 210, 251	STONE 41
BARNBRIDGE 258	ERRY 8	McNAB 78	STORER 113
BASTON 226	FEATHERSTONE 25	MILES 245, 322	STOW 173, 174, 272
BATES 234	FIELD 315	MONK 157	STOWELL 33
BEEKE 77	FRANCIS 275	MOTT 130	STRATTON 222
BELLAMY 204	FRENCH 33	MOYCE 37, 295-297,	SUMMERS 12, 161,
BENNETT 305, 306	FRY 187	301,	167,
BEVAN 256, 257	R.G. 217	302	168, 170, 171
BIGNELL 263	GALL 236	MURRAY 21	SWIFT 225
BLACKFORD 313	GARNER 51-53	Murrell 342	TAPLEY 117, 341, 342
BLATCHER 197, 199	GASSON 331	NEAL 308	TAYLOR 23, 24, 115,
BOTTEN 77	GATTIE 76	NEALE 308	155
BRYANT 340	GIBES 310	NEWMAN 55, 231, 232	THORPE 276
BURGESS 280	GOLLAND 131	NORBURN 43	TOMLIN 307
BURNLEY 179	GREEN 246-248	OLIVER 156, 158, 163,	TOWNSEND 100
BUSAIN 84	GRIGORY 181	174, 201-203	Tretwicke 334
Butcher 250	HALE 2	ONGLEY 78	PINE 335
M. C., O.C. 163a, 164	HAMPSON 298	PACKHAM 88	TURINGS 188
CAINE 13, 14	HARRISON 87	PALEY 4, 5	TURLEY 313
CAMDEN 24, 86	HAYES 55, 58	PALMER 95	TURNER 112, 114
CARLLER 229	HAYMAN 121	PANKHURST 200	TYE 265
CARNELL 49, 50	HEATH 250	PARKER 59	USBORNE 1
CARTER 277	HEAVER 57	PECKHAM 69	VENNALL 132, 133,
CATT 243, 244	HESTER 18, 20	PENNY 209	146-148, 211-214
CHILMAID 44-47	HICKMOTT 43	PORTER 33, 35, 56	VINCENT 6, 316-318
CHRISTOPHER 152,	HIGGINS 198	POWIS 249	WAITE 116
157	HILL 240	PRALL 323	WAKER 104
CLARKE 262	HILLS 135-138, 150,	PRICE 267	WALKER 32
CLEMENTS 67	151,	PYNE 73	WALTER 30, 31, 298
COLE 273, 274	185, 186	RANDALL 221, 223	WATERMAN 336
COLYER 175	HIND 191, 193	RELPH 9, 126-128	WATERS 36
COOMBER 260	HOATH 261	RICH 252, 253	WEBB 85
CORKE 334, 337, 338	HOBBS 309	RICHARDS 269, 270,	WEGG 219, 237, 238
CORNEY 264	HOLMDEN 60-62	332,	WEST 254
COURTEEN 235	HOOK 290	333	WICKENDEN 287
COWHARD 139-141	HUBBLE 43	RICHARDSON 233, 306	WIDEN 119, 122
COWLARD 144	HUGHES 325	ROBINSON 341, 342	WILLIAMS 87
COYL 129	JEFFREY 255	ROGERS 184	WISE 101, 102, 268
CRIPPS 176	JOHNSON 74, 75, 189	ROOTS 7, 131, 207, 208	WOOD 172, 330
CRONK 117, 118, 120-	JONES 324	ROSE 224, 226-228	WOODGATE
125,	KEEBLE 189, 190, 196	SHARP 15	63,97,98,343
196	KENNARD 293, 294	SHERRATT 206	WOOLLGAR 55
GRUNDELL 3	KIPPS 34, 38, 39	SHIELLS 16	YOUNG 96
		SHOEBRIDGE 9, 10,	
		64-68	
		SHOTT 259	

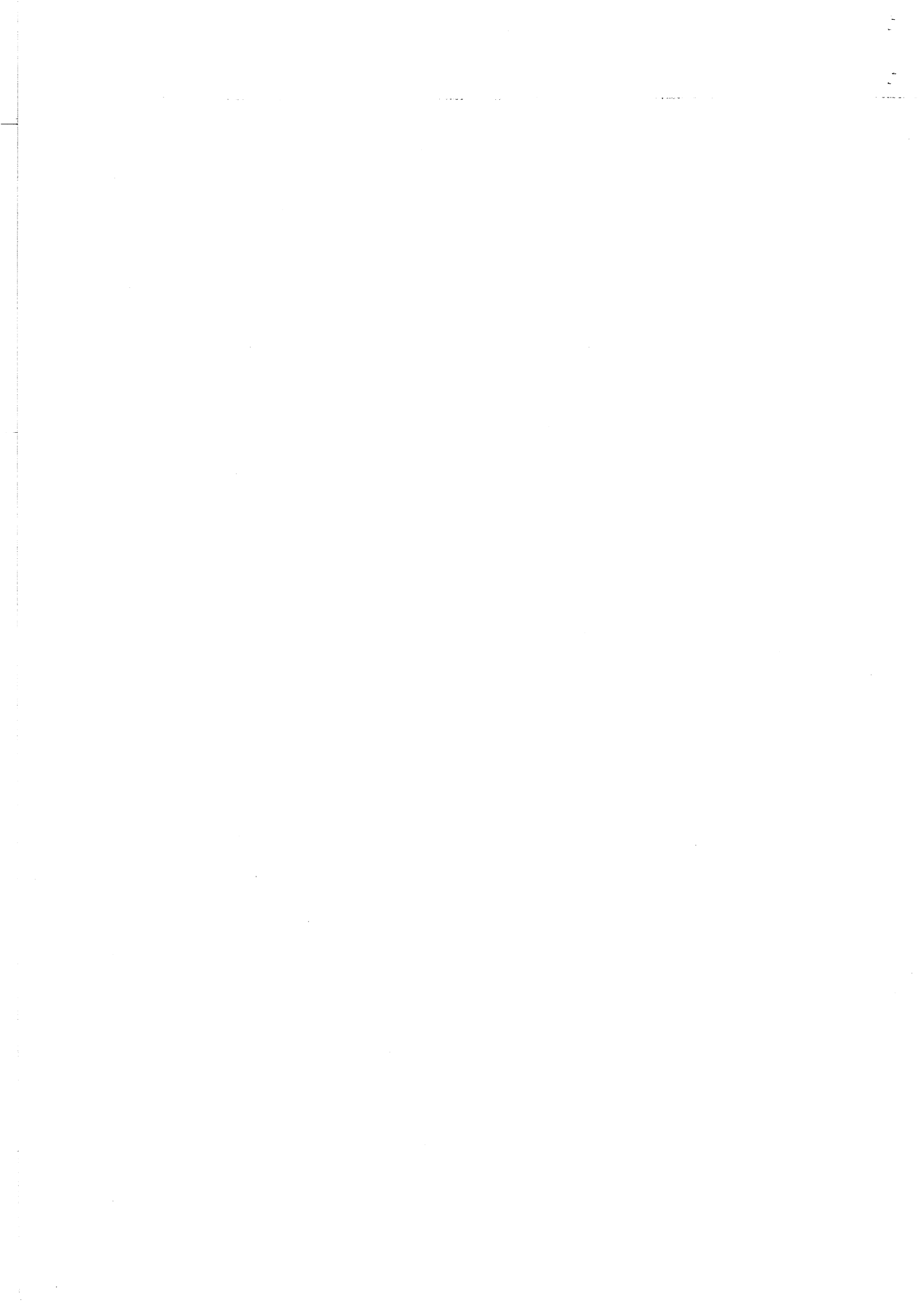

# Leland Duncan map 1921

Grave numbers refer to record set 1

